

ROAD & PEDESTRIAN SAFETY IMPROVEMENTS ON GUILDFORD WAY AND DAVID AVE

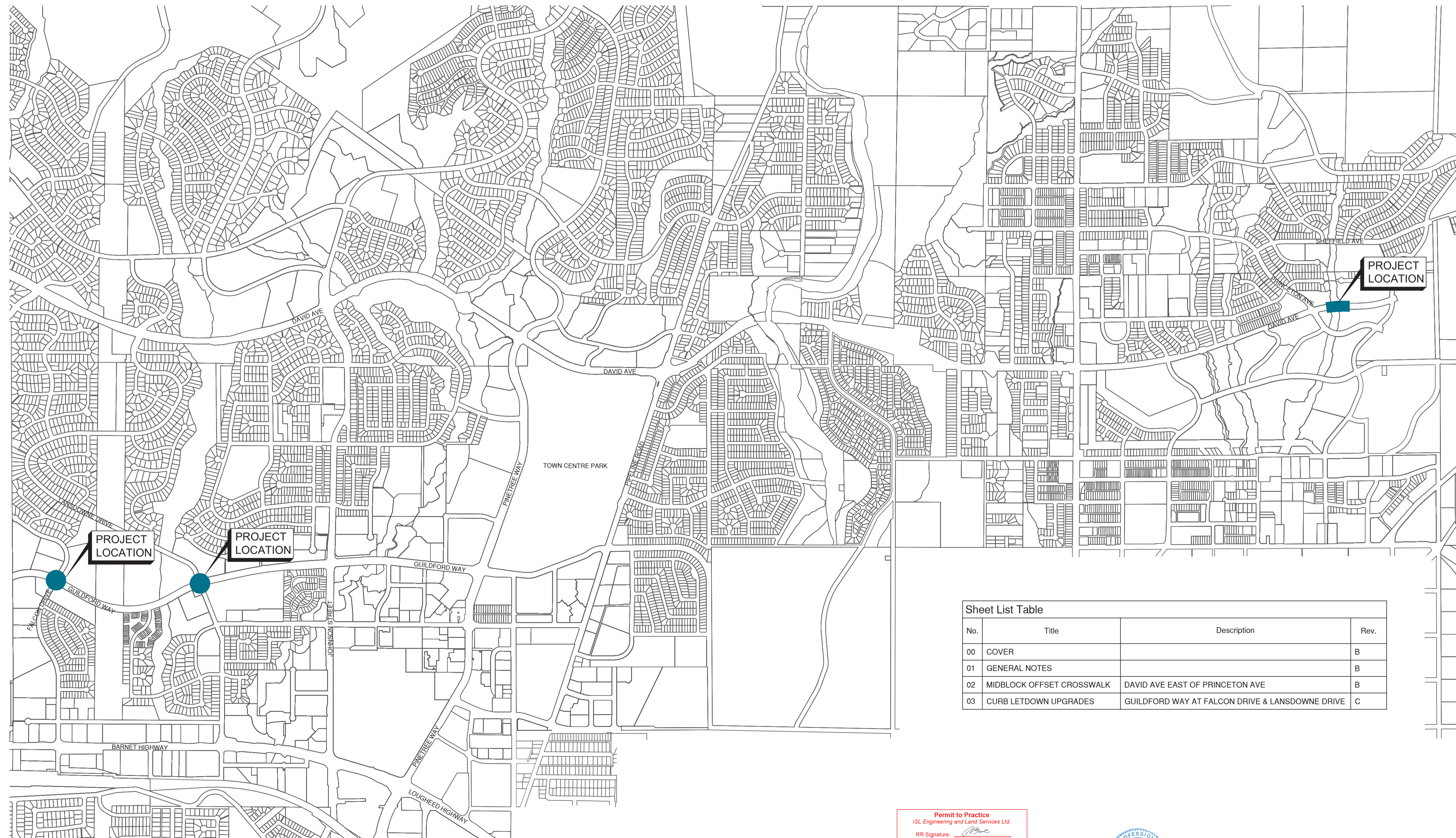

Sheet List Table			
No.	Title	Description	Rev.
00	COVER		B
01	GENERAL NOTES		B
02	MIDBLOCK OFFSET CROSSWALK	DAVID AVE EAST OF PRINCETON AVE	B
03	CURB LETDOWN UPGRADES	GUILDFORD WAY AT FALCON DRIVE & LANSDOWNE DRIVE	C

Permit to Practice
 ISL Engineering and Land Services Ltd.
 RR Signature: 
 RR E.G.S.C. ID: 42221
 Date: 2026-03-16
 Permit Number 1000419
 Engineers & Geoscientists British Columbia

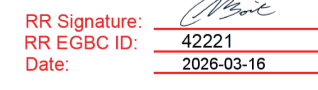

GENERAL NOTES:

1. ALL MATERIALS AND CONSTRUCTION SHALL CONFORM TO THE PLATINUM EDITION OF THE MASTER MUNICIPAL CONSTRUCTION DOCUMENTS (MMCD) AND CITY OF COQUITLAM SUPPLEMENTARY SPECIFICATIONS AND DETAIL DRAWINGS UNLESS OTHERWISE NOTED.
2. THE LOCATION OF EXISTING UTILITIES IS COMPILED FROM OWNER AND UTILITY SUPPLIED RECORD DRAWINGS AND ARE CONSIDERED APPROXIMATE ONLY. THE EXACT LOCATION AND EXTENT OF UTILITIES SHOULD BE DETERMINED BY CONSULTING THE LOCAL AUTHORITIES AND UTILITY COMPANIES CONCERNED. THE CONTRACTOR SHALL VERIFY THE EXACT LOCATION AND INVERT ELEVATION BY HAND OR HYDROVAC EXCAVATION BEFORE CONSTRUCTION OF UTILITY CROSSINGS AND SHALL BE RESPONSIBLE FOR RESTORATION OF ANY DAMAGE TO EXISTING UTILITIES. ANY COSTS ASSOCIATED WITH UTILITY CONFLICTS THAT WERE NOT PRELOCATED WILL BE THE CONTRACTORS RESPONSIBILITY.
3. NOTIFY THE CITY OF COQUITLAM 48 HOURS IN ADVANCE OF ANY CONSTRUCTION OR UTILITY RELOCATION.
4. REPORT ANY DISCREPANCIES TO THE DESIGN ENGINEER A MINIMUM OF 72 HOURS PRIOR TO CONSTRUCTION.
5. RESTORATION OF EXISTING DRIVEWAYS AND WALKWAYS TO CONFORM TO CITY SPECIFICATIONS.
6. BOULEVARDS ARE TO BE CONSTRUCTED TO THE PLATINUM EDITION OF THE MASTER MUNICIPAL CONSTRUCTION DOCUMENTS (MMCD) AND CITY OF COQUITLAM SUPPLEMENTARY SPECIFICATIONS AND DETAIL DRAWINGS UNLESS OTHERWISE SHOWN ON CONTRACT DRAWINGS. BOULEVARDS TO BE SLOPED TO INSPECTION CHAMBERS WHERE APPLICABLE.
7. EVERY EFFORT IS TO BE MADE TO SAVE EXISTING LANDSCAPING WITHIN THE ROAD R.O.W. LANDSCAPING IS TO BE RESTORED TO ITS ORIGINAL OR BETTER CONDITION. IN THE EVENT OF LANDSCAPING REMOVAL THE PROPERTY OWNER SHALL BE ADVISED OF THE REMOVAL AND THE LANDSCAPING PLACED IN OWNERS PROPERTY UPON THEIR REQUEST.
8. ALL SURVEY MONUMENTS WITHIN THE PROJECT BOUNDARIES SHALL BE PROTECTED DURING THE COURSE OF THE WORK. SHOULD ANY SURVEY MONUMENT REQUIRE RAISING OR RELOCATION, THE CONTRACTOR SHALL NOTIFY THE CITY ENGINEERING AND OPERATIONS DEPARTMENT AT LEAST 72 HOURS IN ADVANCE OF SCHEDULING WORK. ALL DISTURBED MONUMENTS WILL BE REPLACED BY A B.C. LAND SURVEYOR AT THE CONTRACTOR'S EXPENSE.
9. SURVEY PINS DISTURBED DURING THE COURSE OF CONSTRUCTION SHALL BE REPLACED BY A B.C. LAND SURVEYOR AT THE CONTRACTOR'S EXPENSE.
10. ALL PUBLIC ROADWAYS AFFECTED BY THE WORKS SHALL BE KEPT IN A CLEAN STATE AT ALL TIMES. DUST CONTROL MEASURES SHALL ALSO BE EMPLOYED DURING THE COURSE OF THE WORK.
11. THE CONTRACTOR IS SOLELY RESPONSIBLE FOR CONSTRUCTION MEANS, METHODS, TECHNIQUES, SEQUENCES AND PROCEDURES, AND FOR COORDINATING THE VARIOUS PARTS OF THE WORK. THE CONTRACTOR IS RESPONSIBLE TO ENSURE THAT THERE IS NO DISRUPTION TO SERVICE, AND IF DISRUPTION IS ANTICIPATED, TO NOTIFY THE DESIGN ENGINEER A MINIMUM OF 72 HOURS PRIOR, AND OBTAIN APPROVAL FOR THE DISRUPTION.
12. THE CONTRACTOR SHALL PROVIDE TEMPORARY UTILITY POLE SUPPORTS NECESSARY TO COMPLETE THE WORKS AS AN INCIDENTAL ITEM TO GENERAL CONTRACT REQUIREMENTS WHERE AND AS REQUIRED.
13. CONTRACTOR TO MAINTAIN AN UP TO DATE SET OF AS-CONSTRUCTED DRAWINGS AT ALL TIMES. AS-CONSTRUCTED DRAWINGS TO BE DELIVERED TO THE ENGINEER AT SUBSTANTIAL PERFORMANCE FOR PREPARATION OF FINAL RECORD DRAWINGS. THE ENGINEER SHALL BE PROVIDED ACCESS TO REVIEW THE AS-CONSTRUCTED DRAWINGS AT ALL TIMES TO CONFIRM THEY ARE UP TO DATE.
14. THE CONTRACTOR SHALL MAINTAIN AND MONITOR THE PROVISIONS FOR EROSION CONTROL AND SEDIMENT AS PER CONTRACT DOCUMENTS.
15. THE CONTRACTOR SHALL ADJUST ALL AFFECTED MANHOLE FRAME AND COVERS A MIN. 24 HOURS PRIOR TO FINAL TOP LIFT PAVING. ANY ADJUSTMENTS THAT DO NOT MEET MMCD TOLERANCES SHALL BE IMMEDIATELY RESET AND CORRECTED.
16. ALL PAVEMENT MARKINGS TO BE THERMOPLASTIC.
17. ALL TOP LIFT PAVING JOINTS TO BE LOCATED UNDER THE THERMOPLASTIC CENTERLINE PAVEMENT MARKINGS.
18. ALL ASPHALT JOINTS MUST BE SMOOTH AND WITHOUT VISIBLE BREAKS IN GRADE.
19. SUBMIT DENSITY TESTS TAKEN ON JOINTS. NO INDIVIDUAL TEST LESS THAN 95% DENSITY.
20. ALL LANE DIMENSIONS ARE MEASURED TO THE CENTER OF LANE LINES (FOR DOUBLE LINE THE MEASUREMENT IS TO THE MIDDLE POINT BETWEEN THE 2 LINES).

TRAFFIC MANAGEMENT, NOTIFICATION AND APPROVALS NOTES:

1. THE CONTRACTOR SHALL PROVIDE CONSTRUCTION SIGNAGE, BARRIERS, FLASHING INDICATORS, ETC. AT ALL TIMES TO ENSURE THE SAFETY OF THE PUBLIC. TRAFFIC CONTROL WILL BE REQUIRED FOR ALL CONSTRUCTION WORKS WITHIN THE TRAVELED PORTION OF THE ROAD. NO ROAD SHALL BE CLOSED WITHOUT THE WRITTEN CONSENT OF THE DIRECTOR OF ENGINEERING AND OPERATIONS.
2. THE CONTRACTOR SHALL BE RESPONSIBLE FOR THE DISPOSAL OF ALL EXCAVATED MATERIAL UNSUITABLE FOR REUSE AT A SUITABLE OFF-SITE DISPOSAL AREA, IN ACCORDANCE WITH ALL APPLICABLE REGULATIONS.
3. THE CONTRACTOR SHALL ENSURE THAT ALL APPROVALS REQUIRED FOR THE PROPOSED WORKS HAVE BEEN OBTAINED FROM ALL AUTHORITIES AND AGENCIES PRIOR TO COMMENCING THE WORK.
4. THE CONTRACTOR SHALL ARRANGE FOR, AND COORDINATE THE WORKS DONE BY:
 - CITY OF COQUITLAM; AND
 - FRANCHISE UTILITIES (BC HYDRO, FORTIS GAS, BC TRANSMISSION CORP., SHAW CABLE, TELUS AND METRO VANCOUVER).
5. THE CONTRACTOR SHALL CONTACT THE APPROPRIATE PERSONNEL AT LEAST 72 HOURS PRIOR TO THE WORK. SCHEDULING AND OTHER CONSTRUCTION CONSTRAINTS IMPOSED BY THESE WORKS SHALL BE TAKEN INTO ACCOUNT.
6. RESIDENTS DIRECTLY AFFECTED BY CONSTRUCTION OF THESE WORKS AND SERVICES SHALL BE GIVEN 5 DAYS WRITTEN NOTICE OF THE PROPOSED START OF CONSTRUCTION. THE CONTRACTOR IS TO DISTRIBUTE A NOTICE OF CONSTRUCTION LETTER TO ALL AFFECTED RESIDENTS AND BUSINESSES. FOLLOWING CONSTRUCTION ACTIVITY ON ANY PRIVATE PROPERTY, A WRITTEN RELEASE MAY BE REQUIRED FROM THE PROPERTY OWNER AT THE DISCRETION OF THE CITY.
7. A TRAFFIC AND PEDESTRIAN SAFETY CONTROL PLAN SHALL BE SUBMITTED BY THE CONTRACTOR PRIOR TO THE PRE-CONSTRUCTION MEETING.
8. APPROVALS FOR REQUIRED TREE CUTTING OR TRIMMING NOT INDICATED IN CONTRACT DRAWINGS SHALL BE OBTAINED BY THE CONTRACTOR FROM THE CITY PRIOR TO WORK BEING PERFORMED.
9. CONTRACTOR TO OBTAIN APPROVED LANE CLOSURE REQUEST FORM FOR ALL WORKS. APPROVED REQUESTS ARE CIRCULATED TO ALL EMERGENCY SERVICES.
10. CONTRACTOR TO SUBMIT A TRAFFIC MANAGEMENT PLAN WITH LANE CLOSURE REQUEST FOR ALL MAJOR ROADS AND ANY LOCAL ROADS WHICH REQUIRE ANY DETOURS.
11. ALL TRAFFIC CONTROL TO CONFORM TO THE LATEST EDITION OF THE BC TRAFFIC CONTROL MANUAL FOR WORK ON ROADWAYS.
12. APPROVAL OF NOISE VARIANCE FOR ALL WORK OUTSIDE OF NORMAL APPROVED WORK HOURS REQUIRED BY THE CITY.
13. NOTICE OF CONSTRUCTION SIGNS TO BE INSTALLED AT ALL PROJECT LIMITS AND PREFERRED DETOUR ROUTE. NOTIFY CONTRACT ADMINISTRATOR WITH CONSTRUCTION SCHEDULE AND LOCATIONS. SIGNS PROVIDED AND INSTALLED BY THE CONTRACTOR.
14. THE CONTRACTOR WILL BE RESPONSIBLE FOR COMPLETION OF ALL TAPED TEMPORARY AND PERMANENT PAINT AND THERMOPLASTIC PAVEMENT MARKINGS IN THE PLACE OF THE WORK. PERMANENT LANE MARKINGS ARE TO BE PLACED WITHIN SEVENTY-TWO (72) HOURS OF FINAL PAVING AND PERMANENT THERMOPLASTIC PAVEMENT MARKINGS ARE TO BE PLACED WITHIN FIVE (5) DAYS OF FINAL PAVING. ALL TEMPORARY MARKINGS TO BE REMOVED IMMEDIATELY FOLLOWING PLACEMENT OF PERMANENT PAVEMENT MARKINGS.
15. THE CONTRACTOR SHALL FAMILIARIZE HIMSELF WITH THE TRAFFIC MANAGEMENT DETAILED SPECIFICATIONS IN THE CONTRACT DOCUMENTS.
16. THE CONTRACTOR SHALL COORDINATE ANY TEMPORARY RELOCATION OF BUS STOPS WITH COAST MOUNTAIN BUS COMPANY.

File: z:\Shared\Projects\34020\34500\34550\CADD\20_drawing\20_production\34550_SH_Cover.dwg

REV NO.	REVISION DESCRIPTION	DATE	DRAWN	APPRD
A	PRELIMINARY DESIGN	2026/02/06	SC	CJB
B	ISSUED FOR TENDER	2026/03/13	SC	CJB



ROAD WORKS

GENERAL NOTES

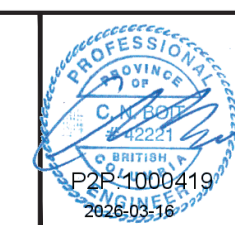

#201, 3999 Hemming Drive, Burnaby, B.C. V5C 6P9
T: (604)293-2598 F: (604)293-2598

ISSUED FOR TENDER DESIGN NO.

78012

SCALE	CREATION DATE	FEBRUARY 6, 2026	DWG. NO.
DRAWN BY SC	DESIGN BY SC		01 OF 03
CHECKED BY CJB	APPROVED BY CNB		
PLOT DATE	March 13, 2026		REV. B

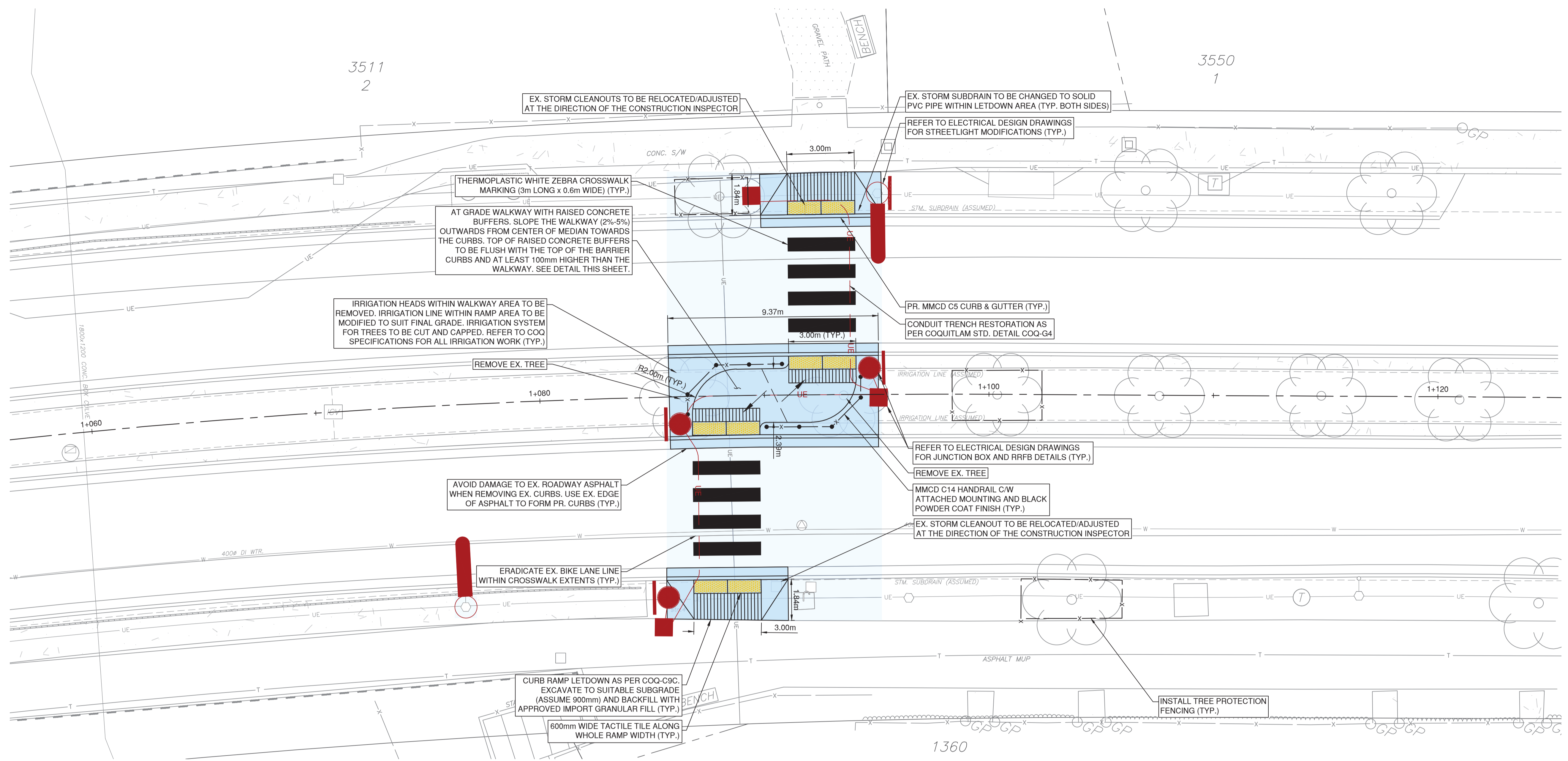

A DAVID AVE CROSSWALK - EAST OF PRINCETON AVE
02 PLAN

SCALE 1:100

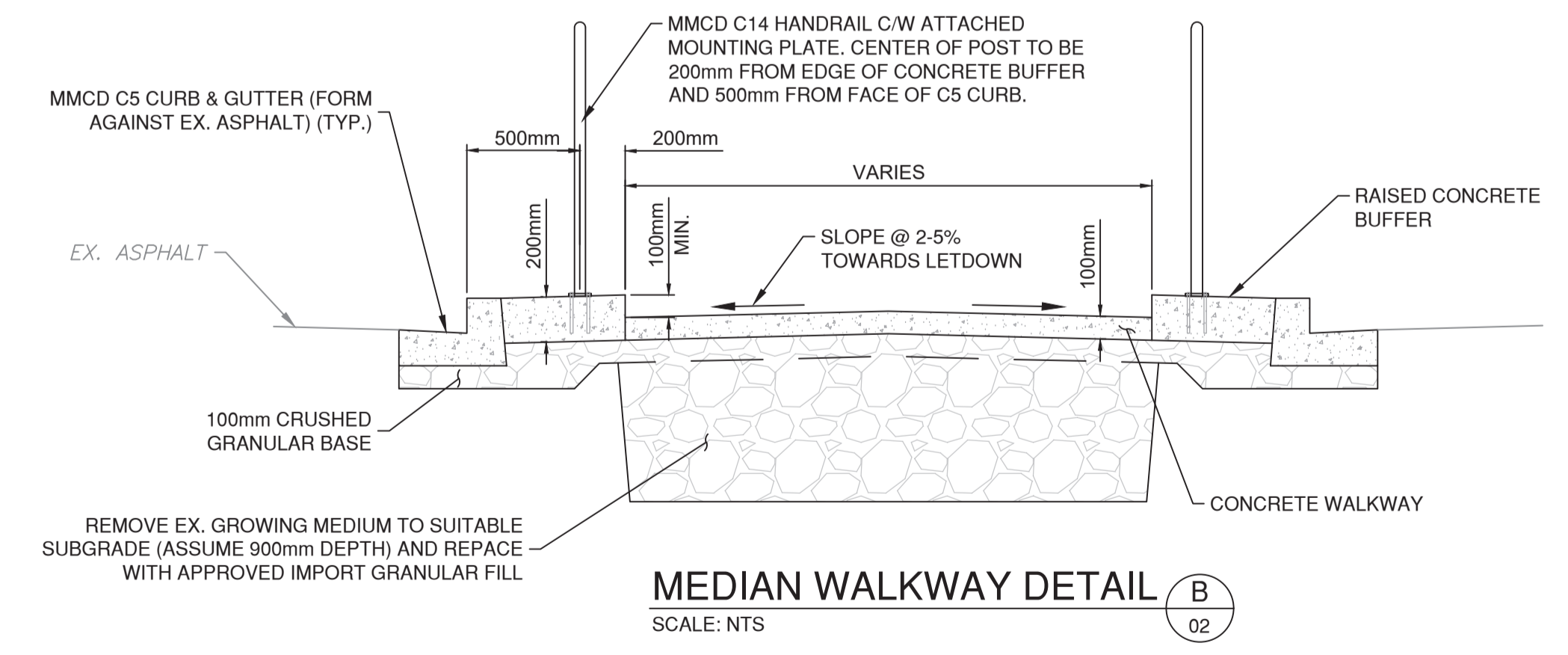

B MEDIAN WALKWAY DETAIL
02 SCALE: NTS

File: z:\Shared\Projects\04020\04500\04550\04550_CADD\02_drawing\02_production\04550_SH_Roadworks.dwg

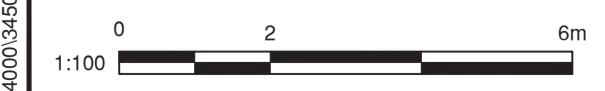

REV NO.	REVISION DESCRIPTION	DATE	DRAWN	APPRD
A	PRELIMINARY DESIGN	2026/02/06	SC	CJB
B	ISSUED FOR TENDER	2026/03/13	SC	CJB



ROAD WORKS

MIDBLOCK OFFSET CROSSWALK
DAVID AVE EAST OF PRINCETON AVE



ISSUED FOR TENDER DESIGN NO.

78012

SCALE	1:100	CREATION DATE	FEBRUARY 6, 2026	DWG. NO.
DRAWN BY	SC	DESIGN BY	SC	02 OF
CHECKED BY	CJB	APPROVED BY	CNB	03
PLOT DATE	March 13, 2026			REV. B

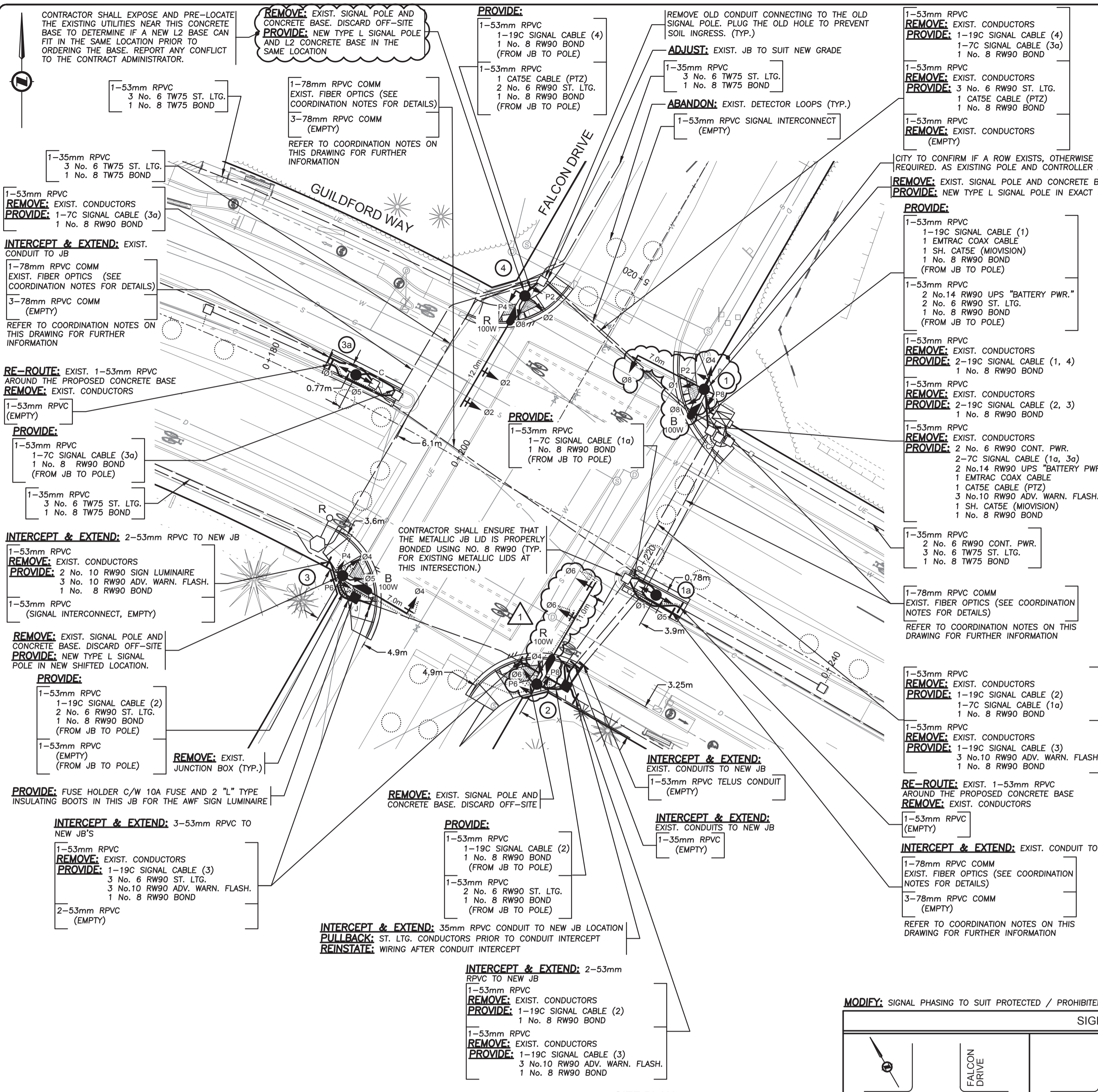

LEGEND

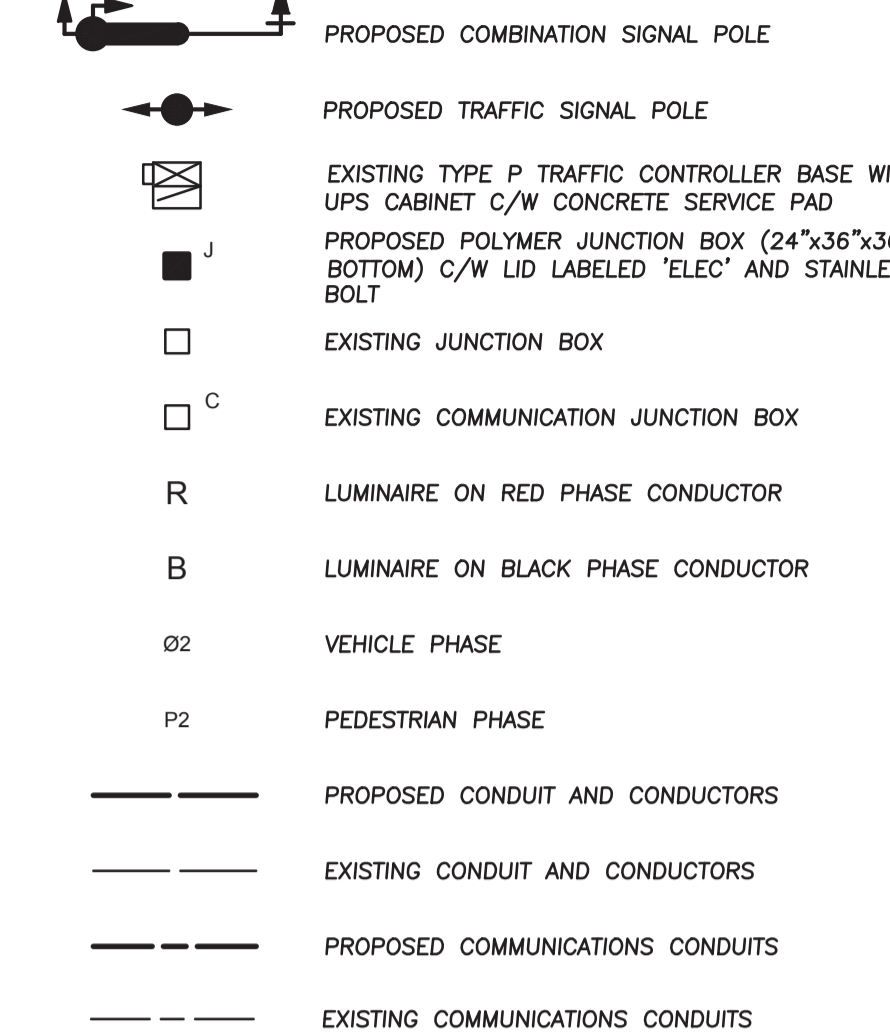

TRAFFIC SIGNAL NOTES

- ALL WORK SHALL BE CONSTRUCTED IN ACCORDANCE (IN ORDER OF PRECEDENCE) WITH THE SUPPLEMENTAL SPECIFICATIONS, MASTER MUNICIPAL CONSTRUCTION DOCUMENT, 2019 ISSUE AND THE CURRENT MOTH STANDARD SPECIFICATIONS FOR HIGHWAY CONSTRUCTION UNLESS OTHERWISE NOTED ON DESIGN DRAWINGS.
- CONDUCTORS INSIDE POLES SHALL BE: No. 15 RW90 X-LINK FOR SIGNALS No. 12 RW90 X-LINK FOR ALL OTHERS
- A TRON HEB AA WEATHERPROOF FUSE HOLDER, C/W A 10A BUSS KTK FUSE AND 2 "L" TYPE INSULATING BOOTS, SHALL BE INSTALLED IN EACH LUMINAIRE & SIGN LIVE CONDUCTOR, IN THE HANDHOLE.
- EXACT POSITION OF ALL EQUIPMENT WILL BE LAYED OUT BY THE CITY REPRESENTATIVE.
- ALL SINGLE CONDUCTORS SHALL BE STRANDED COPPER, TYPE RW90 INSULATED AND COLOR CODED.
- EMPTY CONDUITS SHALL HAVE A No.8 HB POLY YELLOW/GRN MK PULL STRING AND CAPPED AT BOTH ENDS AS PER COQUITLAM SUPPLEMENTARY DRAWING SS-E2.5
- WHERE INDIVIDUAL CONDUCTORS OR CABLES ARE RUN, ALL OF THE COMMON CIRCUITS SHALL BE BUNDLED, TY-RAPPED TOGETHER WITH IDENTIFICATION TAGS IN ALL JUNCTION BOXES, VAULTS, HAND HOLES, CONTROLLER AND ACCESS POINTS AS NOTED IN THE MMCD. TAGS SHALL BE MARKED AS FOLLOWS CABLE N/W POLE, STREET LIGHTING CTS R OR B, PHOTOCELL, CONTROLLER POWER, WITH BLACK INDELEBIL MARKING PEN. TAGS TO BE ATTACHED NO FURTHER THAN 75mm FROM WIRE OR CABLE TERMINATION POINT.
- TRAFFIC SIGNAL NEUTRALS SHALL BE KEPT SEPARATE FROM STREET LIGHTING NEUTRAL CONDUCTORS.
- ALL SIGNAL HEADS AND LUMINAIRES SHALL BE BONDED WITH A SEPARATE No.12 RW90 CONDUCTOR (GREEN) AT THE HANDHOLE, AS REQUIRED.
- EQUIPMENT MODELS SPECIFIED SHALL BE CONFIRMED WITH THE CITY IMMEDIATELY PRIOR TO THEIR PURCHASE TO ENSURE THAT THEY ARE CORRECT AND CURRENT. CUTSHEETS, EQUIPMENT MAKE, MODEL & SERIAL LIST TO BE PROVIDED FOR EACH SIGNAL LOCATION.
- ALL CONDUITS ENTERING POLES AND CABINETS SHALL BE SEALED WITH "DUCT SEAL".
- SEE B.C. HYDRO STANDARDS FOR SERVICE CONNECTION DETAILS.
- CONTRACTOR SHALL CONFIRM EXACT SERVICE LOCATIONS WITH B.C. HYDRO PRIOR TO CONSTRUCTION.
- CONTRACTOR IS REQUIRED TO PROVIDE 72 HOURS NOTICE PRIOR TO ANY CONSTRUCTION.
- TRAFFIC CONTROL IS REQUIRED TO CITY STANDARDS. (Mo+T)
- ALL POLES, ARMS, SERVICE BASES, ETC. TO BE GALVANIZED, PRIMED AND POWDER-COATED IN COLOUR, EQUIVALENT TO COQUITLAM LAMP STANDARD GREEN RAL 6028, UNLESS OTHERWISE NOTED OR APPROVED.
- INSTALL BELL END FITTING ON ALL CONDUITS ENTERING JUNCTION BOXES.
- INSTALL HANGER BAR & TY-RAP WIRES TO BAR IN JUNCTION BOXES AS PER MMCD DRAWING COQUITLAM SUPPLEMENTARY DRAWING SS-E2.5
- ALL CONDUITS SHALL BE BURIED MINIMUM 600mm DEEP. A 'BURIED CABLE' MAKER TAPE SHALL BE INSTALLED 300mm ABOVE CONDUIT IN ALL TRENCHES. DETECTABLE (METALIC) TAPE TO BE USED ABOVE CONDUIT IN TRENCHES CONTAINING ONLY INTERCONNECT CONDUIT.
- BOND ALL STEEL JUNCTION BOX LIDS.
- CONTRACTOR SHALL REPLACE ALL ASPHALT, CONCRETE SIDEWALKS AND WHEELCHAIR RAMPS REMOVED FOR THE INSTALLATION OF THE SIGNAL AND COMM EQUIPMENT, AND RESTORE TO THE SAME OR BETTER CONDITION.
- BACKBOARDS WITH PLUMBIZER GAPS OR KNOCKOUT SECTIONS WILL NOT BE ACCEPTED FOR ANY HEAD MOUNTED WITH OTHER THAN PLUMBIZER STYLE HARDWARE.
- ALL ELECTRICAL PRODUCTS SHALL BEAR CSA/ETC APPROVALS OR BC ELECTRICAL INSPECTION PRIOR TO INSTALLATION.
- SIGNAL WIRING SHALL BE TAGGED AND LABELED USING PANDUIT MP250-C TAGS AND THE APPROPRIATE PANDUIT INDELEBIL MARKER.
- SECURITY HARDWARE TO BE USED ON ALL POLES, SECURITY BITS ARE TO BE SUBMITTED TO THE CITY AFTER SIGNAL HAS BEEN FULLY COMPLETED.
- ALL GROUND PLATES AND GROUND PLATE CONDUCTORS ARE TO HAVE A MINIMUM OF 5 METERS CLEARANCE BETWEEN THEM.
- CONCRETE VAULTS AND JUNCTION BOXES LOCATED IN NON-PAVED OR NON-SIDEWALK AREAS ARE TO BE PROTECTED FROM MOWER OR EROSION/VEGETATION DAMAGE WITH A 200mm WIDE x 150mm DEEP CONCRETE COLLAR FLUSH WITH TOP EDGES OF THE TOP OF THE BOX LID. COLLAR TO SLOPE DOWN AWAY FROM BOX OPENING AT 3% TO DIRECT WATER AWAY FROM BOX OPENING. REFER TO COQUITLAM SUPPLEMENTARY SPECIFICATION FOR DETAILS.
- JUNCTION BOXES FOR ELECTRICAL APPLICATIONS (TRAFFIC SIGNALS, STREET LIGHTING, ETC.) - THE LIDS SHOULD BE ETCHED ELEC, JUNCTION BOXES FOR COMMUNICATIONS - THE LIDS SHOULD BE ETCHED COMM, ALL UPPERCASE LETTERS.
- POLYMER CONCRETE 24 x 36 x 36 PULL BOXES SHALL BE INSTALLED AS SHOWN ON STANDARD DETAIL MMCD DRAWING E2.5 C/W BOLT DOWN LID. REPLACE 300mm COARSE DRAIN ROCK WITH 300mm FINE DRAIN ROCK.
- BOTTOM OF JUNCTION BOXES SHALL BE OPEN. BOTTOM SECTIONS SHALL BE SUPPORTED WITH CONCRETE BRICKS AND USE CRUSHED GRAVEL TO DRAIN WATER.
- ALL BOLT DOWN JUNCTION BOX LIDS SHALL BE TIER 15 (20k) RATED.
- CONTRACTOR SHALL RE-USE THE EXISTING ETMRAC ANTENNA, MOUNTING BRACKET AND OTHER ASSOCIATED EQUIPMENT. PROVIDE NEW NEOPRENE GASKET MATERIAL TO FORM A SEAL BETWEEN THE BRACKET AND POLE. NEOPRENE SHALL BE FULLY ENCLOSED WITHIN OUTER EDGES OF THE BRACKET SUCH THAT NONE IS VISIBLE AFTER INSTALLATION. ETMRAC CABLE WILL RUN CONTINUOUSLY WITH NO SPLICES FROM CONTROLLER TO THE ETMRAC ANTENNA. TERMINATION OF CABLE TO BE DONE BY COBRA ELECTRIC.

120V SERVICE LOAD
(100A-120/240V SERVICE BASE EAST OF POLE 1 AT NEC)

WATTAGE (W)	OCT.PHASE	EXISTING	REMOVED	NEW	TOTAL No. OF LIGHTS	CURRENT(A)
41W	R	2	0	0	2	0.68A
	B	2	0	0	2	0.68A
54W	R	1	0	0	1	0.45A
	B	0	0	0	0	0.00A
69W	R	2	0	0	2	1.15A
	B	2	0	0	2	1.15A
78W	R	2	0	0	2	1.30A
	B	3	0	0	3	1.95A
84W	R	2	0	0	2	1.40A
	B	2	0	0	2	1.40A
100W	R	4	0	1	5	4.17A
	B	2	0	0	2	1.67A
117W	R	6	0	0	6	5.85A
	B	9	0	0	9	8.78A

2.76% VOLTAGE DROP

EXISTING INFORMATION SHOWN WAS TAKEN FROM THE EXISTING CITY AS-BUILT DRAWINGS. DETAILS ON DRAWINGS ONLY SHOW CHANGES REQUIRED AND MAY NOT ACCURATELY REPRESENT WHAT EXISTS IN FIELD

CONTRACTOR SHALL REMOVE ALL THE EXISTING LOOP CABLES INSIDE THE EXISTING JB

THE CONTRACTOR SHALL ENSURE ALL CONDUITS ENTER THE BOTTOM OF ANY NEWLY INSTALLED JUNCTION BOXES. CONDUITS ENTERING THE SIDE OF THESE NEWLY INSTALLED BOXES WILL NOT BE ACCEPTABLE.

EXISTING FIBRE OPTIC CABLES ON GUILDFORD WAY SHALL REMAIN IN OPERATION AND SHALL BE PROTECTED WHEN NECESSARY UNTIL THE NEW WORKS HAVE BEEN INSTALLED. THE CONTRACTOR SHALL COORDINATE WITH QNET AT LEAST 3 WEEKS PRIOR TO CONSTRUCTION. CONTACT BRENT GALPIN (604-927-3626 / bgalpin@coquitlam.ca) OR DWAIN ROPER (604-927-3605 / droper@coquitlam.ca) TO COORDINATE THE PULL BACK, CUT OVER, SPLICING AND CONNECTIONS. QNET WILL BE RESPONSIBLE FOR SUPPLYING AND INSTALLING THE NEW FIBER OPTIC CABLES AND SPLICE ENCLOSURES. SEE BELOW THE PREFERRED APPROACH BY QNET FOR THE MEDIAN WORKS.

PREFERRED APPROACH BY QNET FOR THE MEDIAN WORKS.

- CONFIRM AND RE-ROUTE THE EXIST. 3-78mm RPVC EMPTY CONDUITS AROUND THE NEW MEDIAN BASE LOCATION.
- RE-INSTALL ALL THE FIBERS WORK INTO THE NEWLY ROUTED COMM DUCTS (BY QNET)
- COMPLETE THE ASSOCIATE MEDIAN SIGNAL WORKS INSTALL AND RE-ROUTE THE LAST CONDUIT INTO THE COMM JB.

ALL EQUIPMENT IS EXISTING EXCEPT WHERE NOTED

NOT FOR CONSTRUCTION
2026-04-02

LOCATING EQUIPMENT

FOR CLARITY CONDUITS, JUNCTION BOXES AND STREETLIGHT POLES MAY NOT BE SHOWN AT DESIGN OFFSETS. CONTRACTOR SHALL LOCATE ALL EQUIPMENT BASED ON STATIONS AND/OR OFFSETS AS NOTED AND SHALL NOT RELY ON COORDINATES OBTAINED FROM DMD DIGITAL DRAWINGS. CONTRACTOR TO REPORT ANY CONFLICTS OR DISCREPANCIES TO DMD & ASSOCIATES PRIOR TO ORDERING EQUIPMENT.

CHECK BEFORE YOU DIG

CONTRACTOR SHALL REFER TO MUNICIPAL RECORD / CIVIL DESIGN DRAWINGS FOR ALL OTHER UTILITIES, SERVICE LOCATIONS, AND DETAILS. THE EXACT LOCATION OF THESE UTILITIES SHALL BE DETERMINED ON SITE BY THE CONTRACTOR. CONTRACTOR TO REPORT ANY CONFLICTS OR DISCREPANCIES TO DMD & ASSOCIATES PRIOR TO ORDERING BASES.

MODIFY: SIGNAL PHASING TO SUIT PROTECTED / PROHIBITED LEFT TURNS

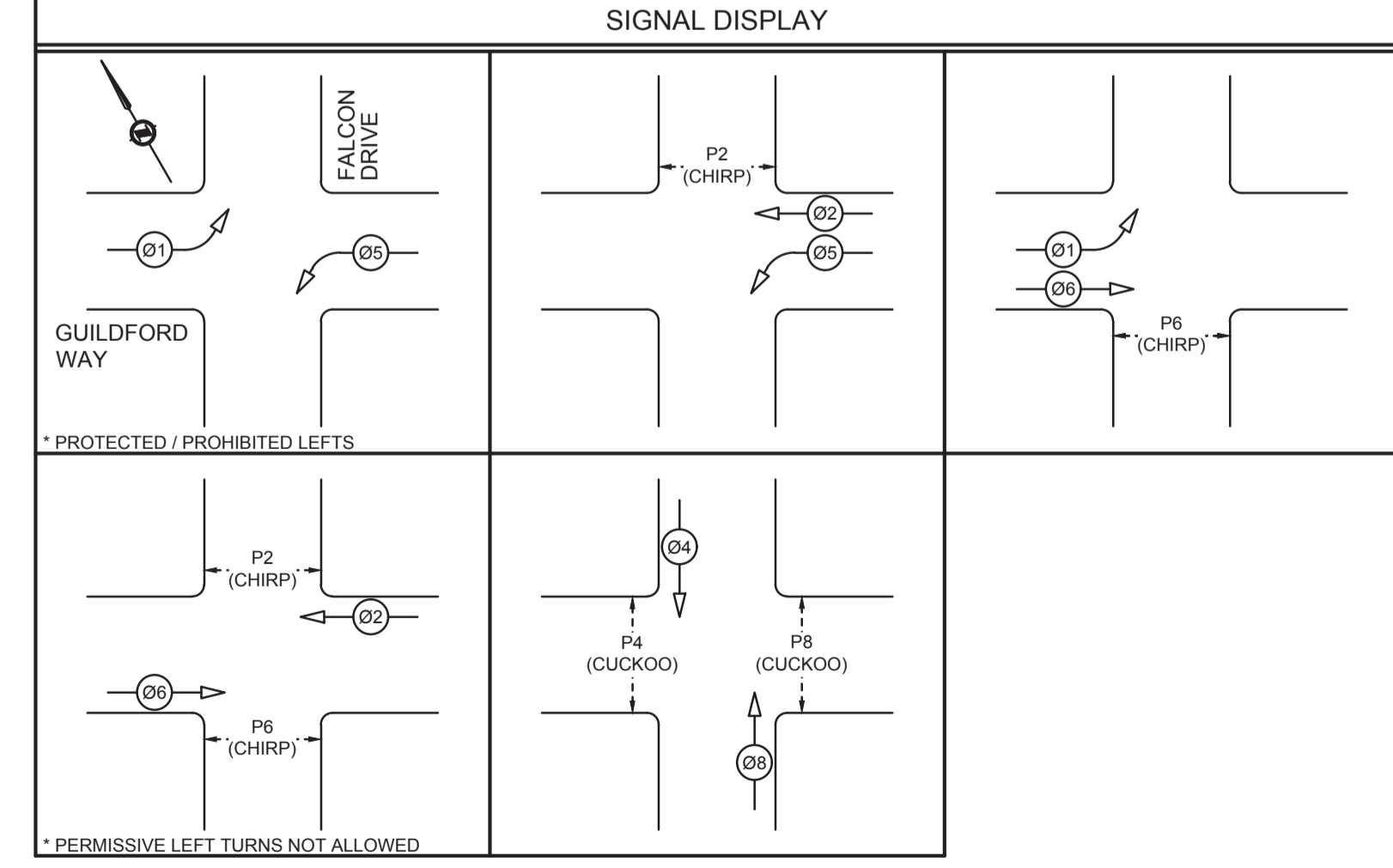

EXISTING STREET LIGHTING SHALL REMAIN IN OPERATION THROUGHOUT CONSTRUCTION. IF TRAFFIC SIGNAL DE-ENERGIZATION IS REQUIRED CONTRACTOR SHALL ENSURE FULL-TIME FLAGGING IS USED DURING ANY TRAFFIC SIGNAL DOWNTIME.

DO NOT USE THIS DRAWING FOR PAVEMENT MARKINGS

ALL JUNCTION BOX LOCATIONS AND CONDUIT ROUTING ARE DIAGRAMMATIC AND ARE NOT TO SCALE. CONTRACTOR TO AVOID UNDERGROUND CONFLICTS AND NOT INSTALL ANYTHING ON PRIVATE PROPERTY.

INTERSECTION DESIGN CRITERIA
PER: (CITY BYLAW 3558)

INTERSECTION (NAME)	GUILDFORD WAY	FALCON DRIVE
LAND USE CLASSIFICATION	RESIDENTIAL	RESIDENTIAL
ROADWAY CLASSIFICATION & WIDTH	ARTERIAL	COLLECTOR
PEDESTRIAN CONFLICT	MEDIUM	MEDIUM
ILLUMINANCE RECOMMENDED/DELIVERED	22.0 LUX	30.3 LUX
UNIFORMITY RECOMMENDED/DELIVERED	3.0:1	2.2:1
LIGHT LOSS FACTOR	0.85	
SPACING	AS SHOWN	
EQUIPMENT		
FIXTURE TYPE: LED	WATTAGE: 100W	MTG. HEIGHT: 9.5m
IES FILE:	NXT-72M-450mA-2ES-4000K	MODEL: NXT-72M- SERIES
FIXTURE TYPE: LED	WATTAGE: 100W**	MTG. HEIGHT: 9.0m
IES FILE:	NXT-72M-450mA-2ES-4000K	MODEL: NXT-72M- SERIES

** BASE ON A 20-YEAR FIXTURE LIFE AND 10-YEAR CLEANING CYCLE
** STREET LIGHTING INCLUDED IN CALCULATION

Benchmark:
Contractor to contact Telus, BC Hydro, FortisBC and BC one call prior to construction to confirm locations of utilities and appurtenances requiring adjustment.

DMD & Associates
Electrical Consultants Ltd.
#12-11588 1044 Avenue, Surrey, BC, Canada V4N 0A3
www.dmdeng.com 604-589-9010
office@dmdeng.com Fax 604-589-9012
DMD PROJECT No. 8358-24-01 of 04

No.	Date	By	Revisions
1	02-04-2026	BG	ADDENDUM #1 SOUTH CORNER POLE AND JB SHIFT
	05-03-2026	BG	ISSUED FOR TENDER
	21-01-2026	BG	DETAILED SUBMISSION
	28-04-2025	BP	PRELIMINARY SUBMISSION

ACCEPTED FOR CONSTRUCTION
Date: _____
Manager of Development Servicing

Coquitlam
Engineering & Public Works
3000 Guildford Way, Coquitlam, B.C. V3B 7N2

PERMIT TO PRACTICE
Signature: _____
Date: 02-04-2026
PERMIT NUMBER: 1000771
The Association of Professional Engineers and Geoscientists of British Columbia



Design by	Date	Scale
BP	12-12-2024	1:250
Drawn by	Date	Sheet of
YJ	12-12-2024	1 OF 4
Checked by	Date	Eng. Project No.
NB	12-12-2024	
Approved by	Date	
	12-12-2024	

Project: **GUILDFORD WAY FALCON DRIVE TRAFFIC SIGNAL MODIFICATIONS**
Description: _____
File: 8358-24
COQ. ASBULT No. **EXXXX**

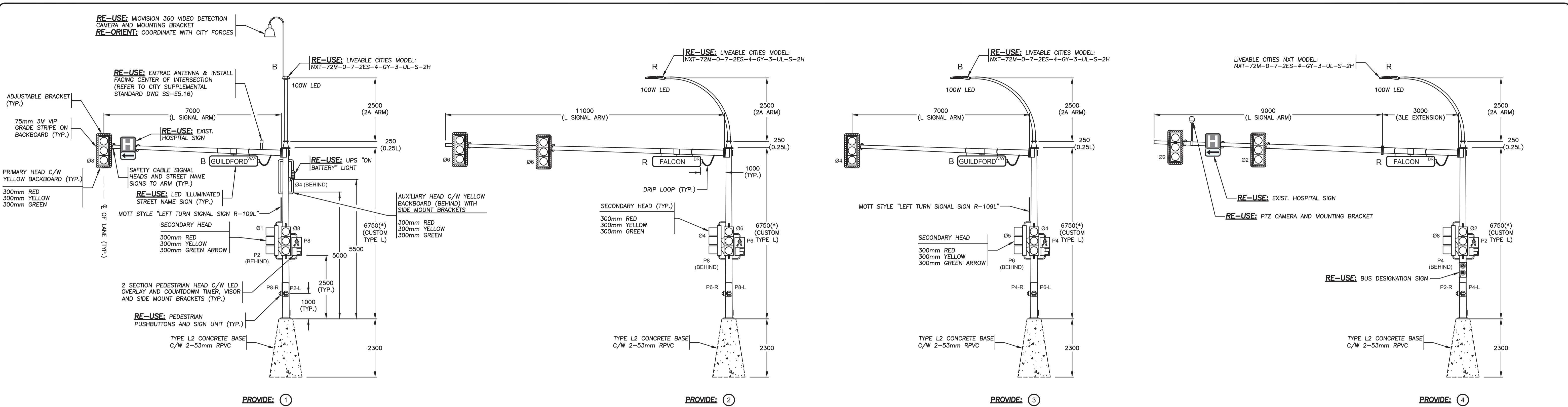

ALL SIGNAL AND PEDESTRIAN DISPLAYS SHALL BE LED

ALL SIGNAL DISPLAYS SHALL HAVE TUNNEL VISORS

NEW POLES DENOTED WITH (*) ARE TO BE CUSTOM. POLE LOADING ANALYSIS MUST BE COMPLETED BY THE POLE MANUFACTURER TO ENSURE POLE(S) ARE CHECKED FOR FATIGUE AND FATIGUE LOADING IN COMPLIANCE WITH CAN/CSA-S6-19 AND AASHTO 2013 SECTION 11 STANDARDS. CONTRACTOR IS REQUIRED TO PROVIDE SIGNED AND SEALED SHOP DRAWINGS FOR ALL NEW POLE(S).

CONDUCTOR COLOUR CODE (FROM HANDHOLE TO SIGNAL)		
ITEM	SIGNAL SECTION	CONDUCTOR COLOUR
#1	RED YELLOW GREEN ARROW	RED (BLUE T.T.) YELLOW (RED T.T.) BLUE (WHITE T.T.)
#2	RED YELLOW GREEN	RED YELLOW BLUE
#4	RED YELLOW GREEN	RED BROWN BLUE
#5	RED YELLOW GREEN ARROW	RED (BLUE T.T.) YELLOW (RED T.T.) BLUE (WHITE T.T.)
#6	RED YELLOW GREEN	RED YELLOW (RED T.T.) BLUE
#8	RED YELLOW GREEN	RED BROWN (ORANGE T.T.) BLUE
P2	DON'T WALK WALK PUSHBUTTON	YELLOW BLUE PURPLE/PURPLE (YELLOW T.T.)
P4	DON'T WALK WALK PUSHBUTTON	BROWN BLUE PURPLE/PURPLE (BROWN T.T.)
P6	DON'T WALK WALK PUSHBUTTON	YELLOW (RED T.T.) BLUE PURPLE/PURPLE (RED T.T.)
P8	DON'T WALK WALK PUSHBUTTON	BROWN (ORANGE T.T.) BLUE PURPLE/PURPLE (ORANGE T.T.)
ITEM	SIGNAL SECTION	CONDUCTOR COLOUR
SIGNAL NEUTRAL	NEUTRAL	WHITE
CONTROLLER/UPS	POWER	BLACK
STREET LIGHTING	POWER	BLACK RED
PANEL SUPPLY	POWER	BLACK RED
PHOTOCELL	POWER	BLACK
	SWITCH LEG	RED
ADVANCE WARNING FLASHER		YELLOW (RD TT)
		BROWN
NEUTRAL	NEUTRAL	WHITE
GROUND/BOND	GROUND/BOND	GREEN

NOTE: T.T. DENOTES TAPE TRACER.

ALL EQUIPMENT IS EXISTING EXCEPT WHERE NOTED

NOT FOR CONSTRUCTION
2026-04-02

CONTRACTOR SHALL OBTAIN A COPY OF THE CITY OF COQUITLAM TRAFFIC SIGNAL AND ROADWAY SUPPLEMENTAL SPECIFICATIONS PRIOR TO CONSTRUCTION.

REFER TO THE CITY OF COQUITLAM TRAFFIC SIGNAL APPROVED PRODUCTS LIST FOR ALL EQUIPMENT DETAILS. IF ANYTHING IS NOT LISTED, COORDINATE WITH CITY TRANSPORTATION GROUP.

USE #7 CONDUCTOR FOR SECONDARY PB RETURN TAPE WHITE IN HANDHOLE & CONTROLLER CABINET.

THE CONTRACTOR SHALL COORDINATE ALL TERMINATION IN THE TRAFFIC CONTROLLER WITH THE CONTRACT ADMINISTRATOR.

THE CITY OF COQUITLAM SHALL BE RESPONSIBLE FOR PROGRAMMING CHANGES TO THE TRAFFIC SIGNAL INCLUDING THE VIDEO DETECTION SYSTEM. CONTRACTOR SHALL PROVIDE THE CITY 3 WEEKS NOTICE IN ADVANCE OF WORK BEING REQUIRED. ALL COST RELATED TO THIS WORK WILL BE BORNE BY THE CITY.



COQ. ASBULT No. EXXXX

Benchmark:
Contractor to contact Telus, BC Hydro, FortisBC and BC one call prior to construction to confirm locations of utilities and appurtenances requiring adjustment.

DMD & Associates
Electrical Consultants Ltd.
 #12-17358 104th Avenue, Surrey, BC, Canada V4N 0A3
 www.dmdeng.com 604-589-9010
 office@dmdeng.com Fax 604-589-9012
 DMD PROJECT No. 8358-24-02 of 04

No.	Date	By	Revisions
1	02-04-2026	BG	ADDENDUM #1 SOUTH CORNER POLE AND JB SHIFT
	05-03-2026	BG	ISSUED FOR TENDER
	21-01-2026	BG	DETAILED SUBMISSION

ACCEPTED FOR CONSTRUCTION
Date: _____
Manager of Development Servicing

Coquitlam
 Engineering & Public Works
 3000 Guildford Way, Coquitlam, B.C. V3B 7N2

PERMIT TO PRACTICE
 Signature: _____
 Date: 02-04-2026
 PERMIT NUMBER: 1000771
 The Association of Professional Engineers and Geoscientists of British Columbia



Design by: _____ Date: 12-12-2024
 Drawn by: YJ Date: 12-12-2024
 Checked by: NB Date: 12-12-2024
 Approved by: _____ Date: 12-12-2024
 Scale: AS NOTED
 Sheet of: 2 OF 4
 Eng. Project No. _____

Project: **GUILDFORD WAY FALCON DRIVE**
 Description: **TRAFFIC SIGNAL MODIFICATIONS**
 File: 8358-24

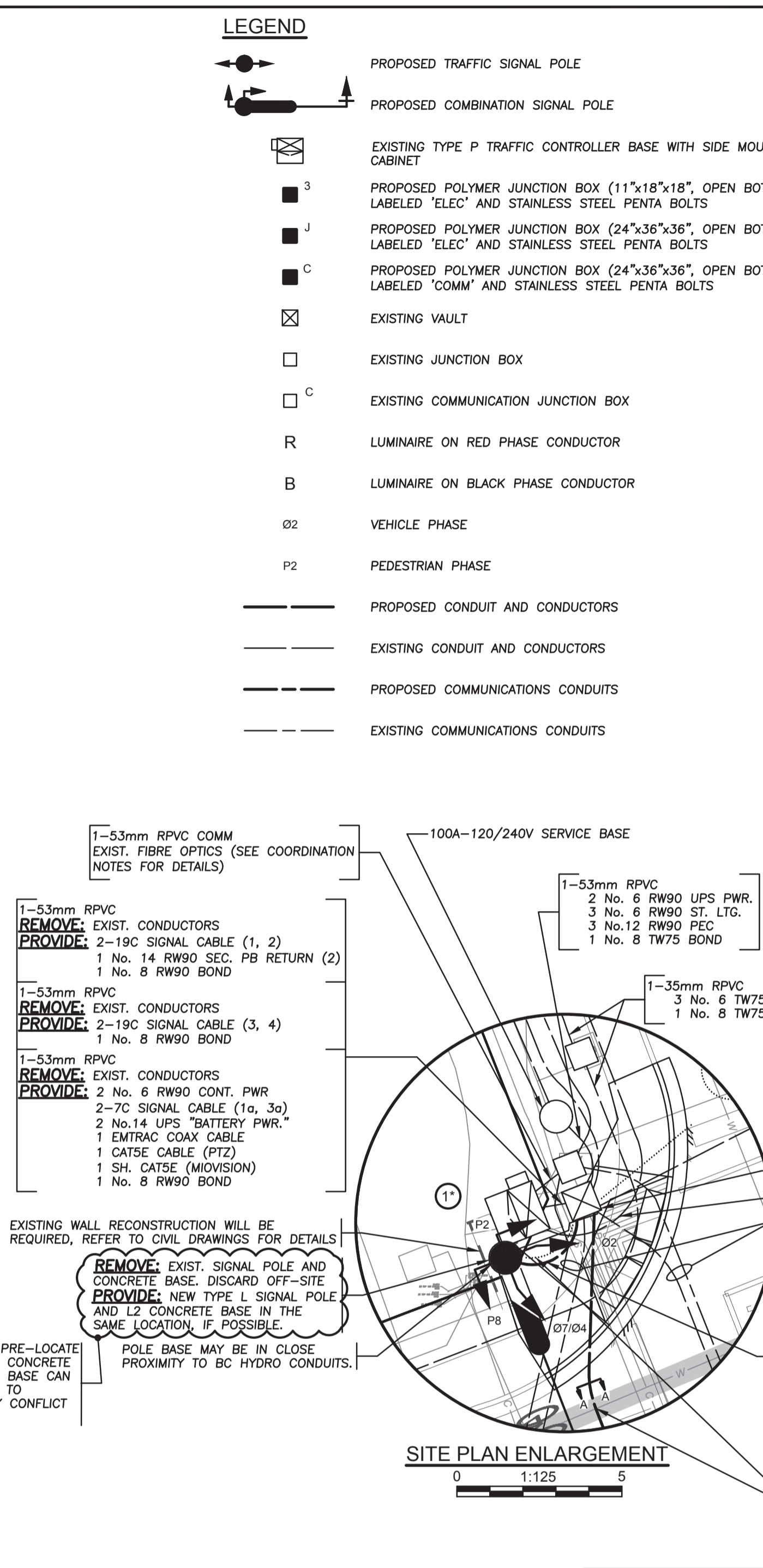
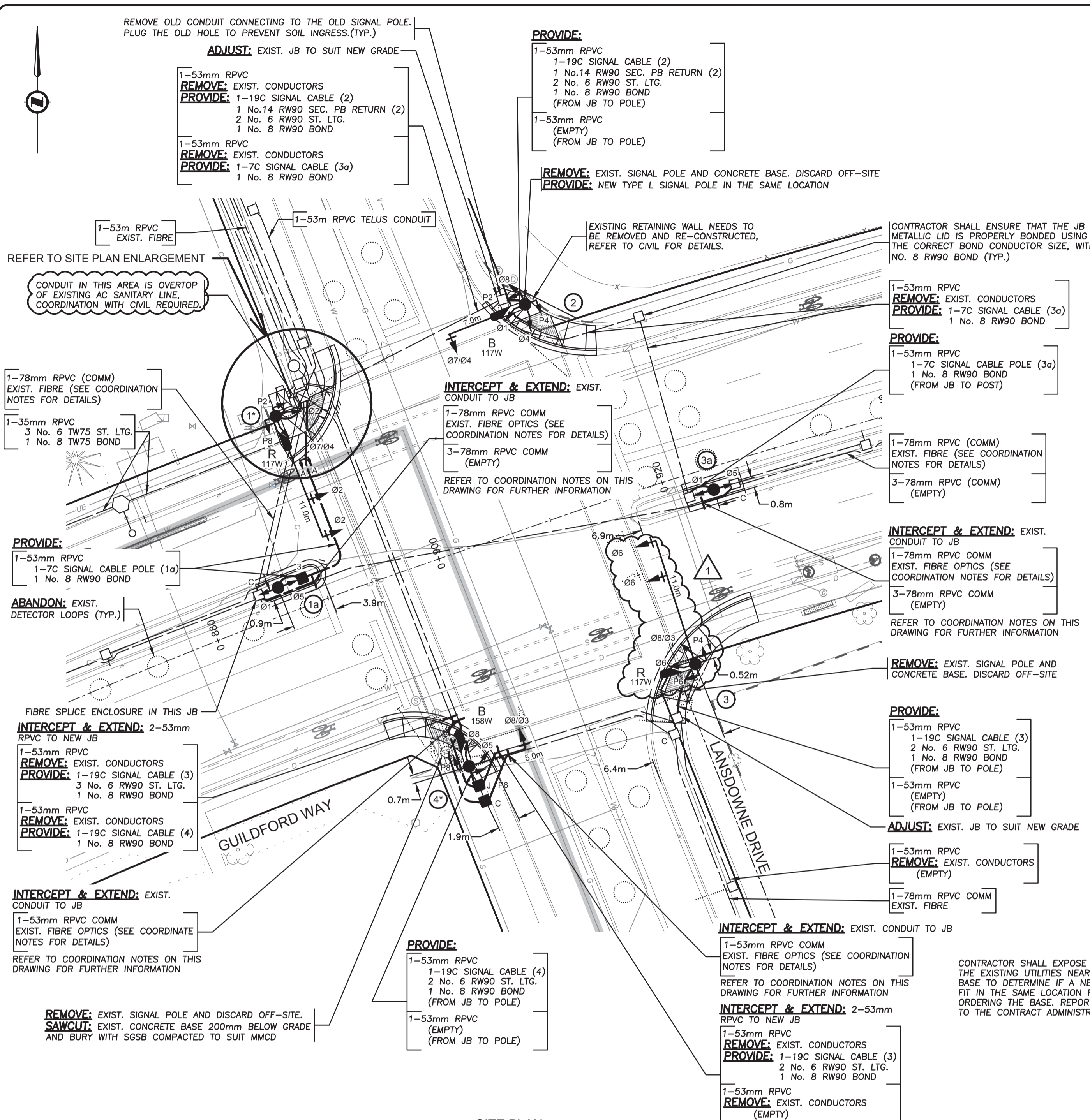

LEGEND

- PROPOSED TRAFFIC SIGNAL POLE
- PROPOSED COMBINATION SIGNAL POLE
- EXISTING TYPE P TRAFFIC CONTROLLER BASE WITH SIDE MOUNT UPS CABINET
- PROPOSED POLYMER JUNCTION BOX (11"x18"x18", OPEN BOTTOM) C/W LID LABELED "ELEC" AND STAINLESS STEEL PENTA BOLTS
- PROPOSED POLYMER JUNCTION BOX (24"x36"x36", OPEN BOTTOM) C/W LID LABELED "ELEC" AND STAINLESS STEEL PENTA BOLTS
- PROPOSED POLYMER JUNCTION BOX (24"x36"x36", OPEN BOTTOM) C/W LID LABELED "COMM" AND STAINLESS STEEL PENTA BOLTS
- EXISTING VAULT
- EXISTING JUNCTION BOX
- EXISTING COMMUNICATION JUNCTION BOX
- LUMINAIRE ON RED PHASE CONDUCTOR
- LUMINAIRE ON BLACK PHASE CONDUCTOR
- VEHICLE PHASE
- PEDESTRIAN PHASE
- PROPOSED CONDUIT AND CONDUCTORS
- EXISTING CONDUIT AND CONDUCTORS
- PROPOSED COMMUNICATIONS CONDUITS
- EXISTING COMMUNICATIONS CONDUITS

TRAFFIC SIGNAL NOTES

- ALL WORK SHALL BE CONSTRUCTED IN ACCORDANCE (IN ORDER OF PRECEDENCE) WITH THE SUPPLEMENTAL SPECIFICATIONS, MASTER MUNICIPAL CONSTRUCTION DOCUMENT, 2019 ISSUE AND THE CURRENT MOTH STANDARD SPECIFICATIONS FOR HIGHWAY CONSTRUCTION UNLESS OTHERWISE NOTED ON DESIGN DRAWINGS.
- CONDUCTORS INSIDE POLES SHALL BE:
 - No. 14 RW90 X-LINK FOR SIGNALS
 - No. 12 RW90 X-LINK FOR ALL OTHERS
- A TRON HEB AA WEATHERPROOF FUSE HOLDER, C/W A 10A BUSS KIT FUSE AND 2 'L' TYPE INSULATING BOOTS, SHALL BE INSTALLED IN EACH LUMINAIRE & SIGN LIVE CONDUCTOR, IN THE HANDHOLE.
- EXACT POSITION OF ALL EQUIPMENT WILL BE LAYED OUT BY THE CITY REPRESENTATIVE.
- ALL SINGLE CONDUCTORS SHALL BE STRANDED COPPER, TYPE RW90 INSULATED AND COLOR CODED.
- EMPTY CONDUITS SHALL HAVE A No.8 HB POLY YELLOW/GRN Mk PULL STRING AND CAPPED AT BOTH ENDS AS PER COQUITLAM SUPPLEMENTARY DRAWING SS-E2.5
- WHERE INDIVIDUAL CONDUCTORS OR CABLES ARE RUN, ALL OF THE COMMON CIRCUITS SHALL BE BUNDLED, TY-RAPPED TOGETHER WITH IDENTIFICATION TAGS IN ALL JUNCTION BOXES, VAULTS, HAND HOLES, CONTROLLER AND ACCESS POINTS AS NOTED IN THE MMCD. TAGS SHALL BE MARKED AS FOLLOWS CABLE N/W POLE, STREET LIGHTING CCTS R OR B, PHOTOCELL, CONTROLLER POWER, WITH BLACK INDELEBIL MARKING PEN. TAGS TO BE ATTACHED NO FURTHER THAN 75mm FROM WIRE OR CABLE TERMINATION POINT.
- TRAFFIC SIGNAL NEUTRALS SHALL BE KEPT SEPARATE FROM STREET LIGHTING NEUTRAL CONDUCTORS.
- ALL SIGNAL HEADS AND LUMINAIRES SHALL BE BONDED WITH A SEPARATE No.12 RW90 CONDUCTOR (GREEN) AT THE HANDHOLE, AS REQUIRED.
- EQUIPMENT MODELS SPECIFIED SHALL BE CONFIRMED WITH THE CITY IMMEDIATELY PRIOR TO THEIR PURCHASE TO ENSURE THAT THEY ARE CORRECT AND CURRENT. CUTSHEETS, EQUIPMENT, MAKE, MODEL & SERIAL LIST TO BE PROVIDED FOR EACH SIGNAL LOCATION.
- ALL CONDUITS ENTERING POLES AND CABINETS SHALL BE SEALED WITH "DUCT SEAL".
- SEE B.C. HYDRO STANDARDS FOR SERVICE CONNECTION DETAILS.
- CONTRACTOR SHALL CONFIRM EXACT SERVICE LOCATIONS WITH B.C. HYDRO PRIOR TO CONSTRUCTION.
- CONTRACTOR IS REQUIRED TO PROVIDE 72 HOURS NOTICE PRIOR TO ANY CONSTRUCTION.
- TRAFFIC CONTROL IS REQUIRED TO CITY STANDARDS. (M.oTT)
- ALL POLES, ARMS, SERVICE BASES, ETC. TO BE GALVANIZED, PRIMED AND POWDER-COATED IN COLOUR. EQUIVALENT TO COQUITLAM LAMP STANDARD GREEN RAL 6028, UNLESS OTHERWISE NOTED OR APPROVED.
- INSTALL BELL END FITTING ON ALL CONDUITS ENTERING JUNCTION BOXES.
- INSTALL HANGER BAR & TY-RAP WIRES TO BAR IN JUNCTION BOXES AS PER MMCD DRAWING COQUITLAM SUPPLEMENTARY DRAWING SS-E2.5
- ALL CONDUITS SHALL BE BURIED MINIMUM 600mm DEEP. A 'BURIED CABLE' MAKER TAPE SHALL BE INSTALLED 300mm ABOVE CONDUIT IN ALL TRENCHES. DETECTABLE (METALIC) TAPE TO BE USED ABOVE CONDUIT IN TRENCHES CONTAINING ONLY INTERCONNECT CONDUIT.
- BOND ALL STEEL JUNCTION BOX LIDS.
- CONTRACTOR SHALL REPLACE ALL ASPHALT, CONCRETE SIDEWALKS AND WHEELCHAIR RAMPS REMOVED FOR THE INSTALLATION OF THE SIGNAL AND COMM EQUIPMENT, AND RESTORE TO THE SAME OR BETTER CONDITION.
- BACKBOARDS WITH PLUMBIZER GAPS OR KNOCKOUT SECTIONS WILL NOT BE ACCEPTED FOR ANY HEAD MOUNTED WITH OTHER THAN PLUMBIZER STYLE HARDWARE.
- ALL ELECTRICAL PRODUCTS SHALL BEAR CSA/ETC APPROVALS OR BC ELECTRICAL INSPECTION PRIOR TO INSTALLATION.
- SIGNAL WIRING SHALL BE TAGGED AND LABELED USING PANDUIT MP250-C TAGS AND THE APPROPRIATE PANDUIT INDELEBIL MARKER.
- SECURITY HARDWARE TO BE USED ON ALL POLES, SECURITY BITS ARE TO BE SUBMITTED TO THE CITY AFTER SIGNAL HAS BEEN FULLY COMPLETED.
- ALL GROUND PLATES AND GROUND PLATE CONDUCTORS ARE TO HAVE A MINIMUM OF 5 METERS CLEARANCE BETWEEN THEM.
- CONCRETE VAULTS AND JUNCTION BOXES LOCATED IN NON-PAVED OR NON-SIDEWALK AREAS ARE TO BE PROTECTED FROM MOWER OR EROSION/VEGETATION DAMAGE WITH A 200mm WIDE x 150mm DEEP CONCRETE COLLAR FLUSH WITH TOP EDGES OF THE TOP OF THE BOX LID. COLLAR TO SLOPE DOWN AWAY FROM BOX OPENING AT 3% TO DIRECT WATER AWAY FROM BOX OPENING. REFER TO COQUITLAM SUPPLEMENTARY SPECIFICATION FOR DETAILS.
- JUNCTION BOXES FOR ELECTRICAL APPLICATIONS (TRAFFIC SIGNALS, STREET LIGHTING, ETC.) - THE LIDS SHOULD BE ETCHED ELEC, JUNCTION BOXES FOR COMMUNICATIONS - THE LIDS SHOULD BE ETCHED COMM, ALL UPPERCASE LETTERS.
- POLYMER CONCRETE 24 x 36 x 36 PULL BOXES SHALL BE INSTALLED AS SHOWN ON STANDARD DETAIL MMCD DRAWING E2.5 C/W BOLT DOWN LID. REPLACE 300mm COARSE DRAIN ROCK WITH 300mm FINE DRAIN ROCK.
- BOTTOM OF JUNCTION BOXES SHALL BE OPEN. BOTTOM SECTIONS SHALL BE SUPPORTED WITH CONCRETE BRICKS AND USE CRUSHED GRAVEL TO DRAIN WATER.
- ALL BOLT DOWN JUNCTION BOX LIDS SHALL BE TIER 15 (20K) RATED.
- CONTRACTOR SHALL RE-USE THE EXISTING EMTRAC ANTENNA, MOUNTING BRACKET AND OTHER ASSOCIATED EQUIPMENT. PROVIDE NEW NEOPRENE GASKET MATERIAL TO FORM A SEAL BETWEEN THE BRACKET AND POLE. NEOPRENE SHALL BE FULLY ENCLOSED WITHIN OUTER EDGES OF THE BRACKET SUCH THAT NONE IS VISIBLE AFTER INSTALLATION. EMTRAC CABLE WILL RUN CONTINUOUS WITH NO SPLICES FROM CONTROLLER TO THE EMTRAC ANTENNA. TERMINATION OF CABLE TO BE DONE BY COBRA ELECTRIC.



INTERSECTION DESIGN CRITERIA
PER: (CITY BYLAW 3558)

INTERSECTION (NAME)	GUILDFORD WAY	LANSDOWNE DRIVE
LAND USE CLASSIFICATION	RESIDENTIAL	RESIDENTIAL
ROADWAY CLASSIFICATION & WIDTH	ARTERIAL	COLLECTOR
PEDESTRIAN CONFLICT	MEDIUM	MEDIUM
ILLUMINANCE RECOMMENDED/DELIVERED	22.0 LUX	26.6 LUX
UNIFORMITY RECOMMENDED/DELIVERED	3.0:1	2.2:1
LIGHT LOSS FACTOR		0.85
SPACING		AS SHOWN
EQUIPMENT		
FIXTURE TYPE: LED	WATTAGE: 117W	MTG. HEIGHT: 9.5m
DIST TYPE: 2ES		
IES FILE:	NXT-72M-525mA-2ES-4000K	MODEL: NXT-72M- SERIES
FIXTURE TYPE: LED	WATTAGE: 158W	MTG. HEIGHT: 9.5m
DIST TYPE: 2ES		
IES FILE:	NXT-72M-700mA-2ES-4000K	MODEL: NXT-72M- SERIES
FIXTURE TYPE: LED	WATTAGE: 117W**	MTG. HEIGHT: 9.0m
DIST TYPE: 2ES		
IES FILE:	NXT-72M-525mA-2ES-4000K	MODEL: NXT-72M- SERIES

** BASE ON A 20-YEAR FIXTURE LIFE AND 10-YEAR CLEANING CYCLE
** STREET LIGHTING INCLUDED IN CALCULATION

DO NOT USE THIS DRAWING FOR PAVEMENT MARKINGS

ALL JUNCTION BOX LOCATIONS AND CONDUIT ROUTING ARE DIAGRAMMATIC AND ARE NOT TO SCALE. CONTRACTOR TO AVOID UNDERGROUND CONFLICTS AND NOT INSTALL ANYTHING ON PRIVATE PROPERTY.

ALL EQUIPMENT IS EXISTING EXCEPT WHERE NOTED

NOT FOR CONSTRUCTION
2026-04-02

(*) PROPOSED POLE LOCATION COULD BE IN CONFLICT WITH EXISTING UNDERGROUND INFRASTRUCTURE. CONTRACTOR SHALL USE EXTREME CAUTION WHEN EXCAVATING AND SHALL EXPOSE AND PRE-LOCATE THE EXISTING UTILITIES NEAR THIS CONCRETE BASE. REPORT ANY CONFLICTS TO THE CONTRACT ADMINISTRATOR PRIOR TO ORDERING CONCRETE BASES AND SIGNAL POLES.

LOCATING EQUIPMENT

FOR CLARITY CONDUITS, JUNCTION BOXES AND STREETLIGHT POLES MAY NOT BE SHOWN AT DESIGN OFFSETS. CONTRACTOR SHALL LOCATE ALL EQUIPMENT BASED ON STATIONS AND/OR OFFSETS AS NOTED AND SHALL NOT RELY ON COORDINATES OBTAINED FROM DMD DIGITAL DRAWINGS. CONTRACTOR TO REPORT ANY CONFLICTS OR DISCREPANCIES TO DMD & ASSOCIATES PRIOR TO ORDERING EQUIPMENT.

CHECK BEFORE YOU DIG

CONTRACTOR SHALL REFER TO MUNICIPAL RECORD / CIVIL DESIGN DRAWINGS FOR ALL OTHER UTILITIES, SERVICE LOCATIONS, AND DETAILS. THE EXACT LOCATION OF THESE UTILITIES SHALL BE DETERMINED ON SITE BY THE CONTRACTOR. CONTRACTOR TO REPORT ANY CONFLICTS OR DISCREPANCIES TO DMD & ASSOCIATES PRIOR TO ORDERING BASES.

EXISTING INFORMATION SHOWN WAS TAKEN FROM THE EXISTING CITY AS-BUILT DRAWINGS. DETAILS ON DRAWINGS ONLY SHOW CHANGES REQUIRED AND MAY NOT ACCURATELY REPRESENT WHAT EXISTS IN FIELD

EXISTING FIBRE OPTIC CABLES ON GUILDFORD WAY SHALL REMAIN IN OPERATION AND SHALL BE PROTECTED WHEN NECESSARY UNTIL THE NEW WORKS HAVE BEEN INSTALLED. THE CONTRACTOR SHALL COORDINATE WITH QNET AT LEAST 3 WEEKS PRIOR TO CONSTRUCTION. CONTACT BRENT GALPIN (604-927-3626 / bgalpin@coquitlam.ca) OR DWAIN ROPER (604-927-3605 / droper@coquitlam.ca) TO COORDINATE THE PULL BACK, CUT OVER, SPLICING AND CONNECTIONS. QNET WILL BE RESPONSIBLE FOR SUPPLYING AND INSTALLING THE NEW FIBER OPTIC CABLES AND SPLICE ENCLOSURES. SEE BELOW THE PREFERRED APPROACH BY QNET FOR THE MEDIAN WORKS AND AT SW CORNER

PREFERRED APPROACH BY QNET FOR THE MEDIAN WORKS.

- CONFIRM AND RE-ROUTE THE EXIST. 3-78MM RPVC EMPTY CONDUITS AROUND THE NEW MEDIAN BASE LOCATION.
- RE-INSTALL ALL THE FIBERS WORK INTO THE NEWLY ROUTED COMM DUCTS (BY QNET)
- COMPLETE THE ASSOCIATE MEDIAN SIGNAL WORKS INSTALL AND RE-ROUTE THE LAST CONDUIT INTO THE COMM JB.

PREFERRED APPROACH FOR SW CORNER

- COORDINATE WITH QNET 3WEEKS PRIOR TO STARTING ANY COMM RELATED WORKS.

THE CONTRACTOR SHALL ENSURE ALL CONDUITS ENTER THE BOTTOM OF ANY NEWLY INSTALLED JUNCTION BOXES. CONDUITS ENTERING THE SIDE OF THESE NEWLY INSTALLED BOXES WILL NOT BE ACCEPTABLE.

EXISTING STREET LIGHTING SHALL REMAIN IN OPERATION THROUGHOUT CONSTRUCTION. IF TRAFFIC SIGNAL DE-ENERGIZATION IS REQUIRED CONTRACTOR SHALL ENSURE FULL-TIME FLAGGING IS USED DURING ANY TRAFFIC SIGNAL DOWNTIME.

BC CALL BEFORE YOU DIG
1-800-474-6886
or by CELLULAR #888
Vancouver Area 257-840

COQ. ASBULT No. **EXXXX**

CALL AT LEAST TWO FULL WORKING DAYS BEFORE YOU PLAN TO DIG

Benchmark:
Contractor to contact Telus, BC Hydro, FortisBC and BC one call prior to construction to confirm locations of utilities and appurtenances requiring adjustment.

DMD & Associates
Electrical Consultants Ltd.
#12-17588 104th Avenue, Surrey, BC, Canada V4N 0A3
www.dmdeng.com 604-589-9010
office@dmdeng.com Fax 604-589-9012
DMD PROJECT No. 8358-24-03 of 04

No.	Date	By	Revisions
1	02-04-2026	BG	ADDENDUM #1 - POLE 2 LOCATION AND POLE TYPE CHANGE
	05-03-2026	BG	ISSUED FOR TENDER
	21-01-2026	BG	DETAILED SUBMISSION
	28-04-2025	BP	PRELIMINARY SUBMISSION

ACCEPTED FOR CONSTRUCTION
Date: _____
Manager of Development Servicing

Coquitlam
Engineering & Public Works
3000 Guildford Way, Coquitlam, B.C. V3B 7N2

PERMIT TO PRACTICE
Signature: _____
Date: 02-04-2026
PERMIT NUMBER: 1000771
The Association of Professional Engineers and Geoscientists of British Columbia

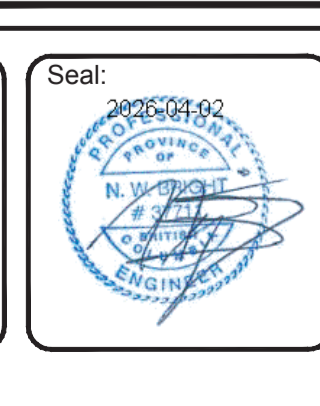

Design by	Date	Scale
BP	12-12-2024	1:250
Drawn by	Date	Sheet of
YJ	12-12-2024	3 OF 4
Checked by	Date	Eng. Project No.
NB	12-12-2024	
Approved by	Date	
	12-12-2024	

Project: **GUILDFORD WAY LANSDOWNE DRIVE TRAFFIC SIGNAL MODIFICATIONS**
Description:
File: 8358-24

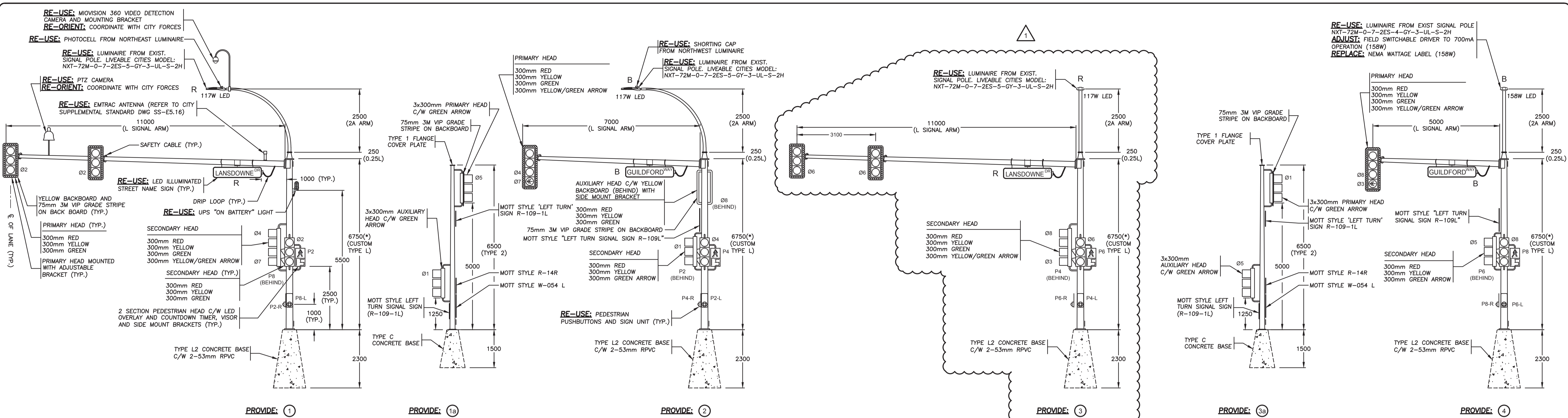

ALL SIGNAL AND PEDESTRIAN DISPLAYS SHALL BE LED
 ALL SIGNAL DISPLAYS SHALL HAVE TUNNEL VISORS

120V SERVICE LOAD
 (100A-120/240V SERVICE BASE AT NEC GUILDFORD WAY AND LANSDOWNE)

WATTAGE (W)	CCT.PHASE	EXISTING	REMOVED	NEW	TOTAL No. OF LIGHTS	CURRENT(A)
84W	R	2	0	0	2	1.40A
	B	2	0	0	2	1.40A
117W	R	2	0	0	2	1.95A
	B	2	1	0	1	0.98A
158W	R	0	0	0	0	0.00A
	B	0	0	1	1	1.32A

0.30% VOLTAGE DROP

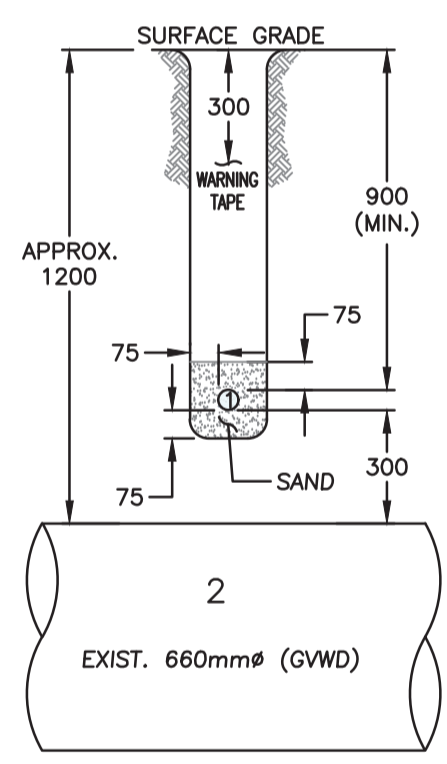

CONTRACTOR TO CONTACT DMD IF TRENCH CANNOT MAINTAIN A MINIMUM OF 900mm BURIAL DEPTH AND 300mm VERTICAL CLEARANCE TO MV WATERMAIN

- AN MV REPRESENTATIVE TO BE ON SITE TO WITNESS THE CROSSING WORK. TO ARRANGE AN MV REPRESENTATIVE, PLEASE CONTACT LPI DESAI AT 604-218-8192 OR Lpi.desai@metrovancover.ca WITH THE TRACKING NUMBER FXW26-00543, NO LESS THAN 10 BUSINESS DAYS PRIOR TO THE COMMENCEMENT OF CONSTRUCTION.
- THE CONTRACTOR IS RESPONSIBLE FOR PHYSICALLY VERIFYING THE DEPTH AND LOCATION OF ALL GWDV WATER MAINS AND OTHER UTILITIES PRIOR TO CONSTRUCTION. OBSERVE THE DISCLAIMERS ON ALL GWDV-SUPPLIED DRAWINGS AND DO NOT RELY SOLELY ON DRAWINGS OR AS-BUILT INFORMATION.
- IF THE WATER MAIN IS TO BE EXPOSED, A HYDRO-EXCAVATOR SHALL BE USED (OR AUTHORIZED OTHERWISE) AND AN MV REPRESENTATIVE MUST BE PRESENT.
- IF AN EXISTING GWDV WATER MAIN IS EXPOSED, THE CONTRACTOR IS RESPONSIBLE TO RESTORE PIPE BEDDING AND BACKFILL TO MV STANDARDS (TO REINSTATE PIPE BEDDING WITH SAND COMPACTED TO 95% MODIFIED PROCTOR).
- THE CONTRACTOR IS TO ENSURE A HORIZONTAL MINIMUM CLEARANCE OF 1000MM AND A VERTICAL MINIMUM CLEARANCE OF 300MM TO GWDV FACILITIES AND APPURTENANCES (MEASURED OUTER EDGE TO OUTER EDGE).
- ONLY USE HAND TOOLS AND HYDRO-EXCAVATOR FOR EXCAVATION WITHIN 500MM OF THE OUTER EDGE OF MV UTILITIES.
- ONLY LOW IMPACT AND LOW VIBRATORY METHODS, SUCH AS LIGHTWEIGHT WALK BEHIND PLATE TAMPER OR JUMPING JACK, ARE PERMITTED WITHIN 3 METERS OF GWDV MAINS. MACHINE HOE-PACK OR VIBRATORY ROLLERS ARE NOT PERMITTED WITHIN THIS ZONE.
- THE COATING OR PIPE MATERIAL OF GWDV WATER MAINS MAY CONTAIN ASBESTOS AND OTHER HAZARDOUS CONTAMINANTS. IF THE COATING WOULD BE DISTURBED DURING THE COURSE OF THE PROXIMAL CONSTRUCTION, IT IS THE RESPONSIBILITY OF THE CONTRACTOR TO EXERCISE APPROPRIATE PRECAUTIONS/SAFETY MEASURES, PERFORM TESTING AND TO CONFORM WITH ALL REGULATORY REQUIREMENTS AS WELL AS ENSURE WORKERS' SAFETY.
- THE CONTRACTOR SHALL BE LIABLE FOR ANY DAMAGES INCURRED AS A RESULT OF THE PROPOSED WORK.

CONDUCTOR COLOUR CODE (FROM HANDLE TO SIGNAL)		
ITEM	SIGNAL SECTION	CONDUCTOR COLOUR
Ø1	RED YELLOW GREEN ARROW	RED (BLUE T.T.) YELLOW (RED T.T.) BLUE (WHITE T.T.)
Ø2	RED YELLOW GREEN	RED YELLOW BLUE
Ø3	YELLOW ARROW GREEN ARROW	ORANGE (WHITE T.T.) BLUE (WHITE T.T.)
Ø4	RED YELLOW GREEN	RED BROWN BLUE
Ø5	RED YELLOW GREEN ARROW	RED (BLUE T.T.) BLUE (WHITE T.T.)
Ø6	RED YELLOW GREEN	RED YELLOW (RED T.T.) BLUE
Ø7	YELLOW ARROW GREEN ARROW	ORANGE (WHITE T.T.) BLUE (WHITE T.T.)
Ø8	RED YELLOW GREEN	RED BROWN (ORANGE T.T.) BLUE
P2	DON'T WALK WALK PUSHBUTTON	YELLOW BLUE PURPLE/PURPLE (YELLOW T.T.)
P4	DON'T WALK WALK PUSHBUTTON	BROWN BLUE PURPLE/PURPLE (BROWN T.T.)
P6	DON'T WALK WALK PUSHBUTTON	YELLOW (RED T.T.) YELLOW PURPLE/PURPLE (RED T.T.)
P8	DON'T WALK WALK PUSHBUTTON	BROWN (ORANGE T.T.) BLUE PURPLE/PURPLE (ORANGE T.T.)
ITEM	SIGNAL SECTION	CONDUCTOR COLOUR
SIGNAL NEUTRAL	NEUTRAL	WHITE
CONTROLLER/UPS	POWER	BLACK
STREET LIGHTING	POWER POWER	BLACK RED
PANEL SUPPLY	POWER POWER	BLACK RED
PHOTOCELL	POWER	BLACK
	SWITCH LEG	RED
NEUTRAL	NEUTRAL	WHITE
GROUND/BOND	GROUND/BOND	GREEN

NOTE: T.T. DENOTES TAPE TRACER.

NEW POLES DENOTED WITH (*) ARE TO BE CUSTOM. POLE LOADING ANALYSIS MUST BE COMPLETED BY THE POLE MANUFACTURER TO ENSURE POLE(S) ARE CHECKED FOR FATIGUE AND FATIGUE LOADING IN COMPLIANCE WITH CAN/CSA-S6-19 AND AASHTO 2013 SECTION 11 STANDARDS. CONTRACTOR IS REQUIRED TO PROVIDE SIGNED AND SEALED SHOP DRAWINGS FOR ALL NEW POLE(S).

EXISTING INFORMATION SHOWN WAS TAKEN FROM THE EXISTING CITY AS-BUILT DRAWINGS. DETAILS ON DRAWINGS ONLY SHOW CHANGES REQUIRED AND MAY NOT ACCURATELY REPRESENT WHAT EXISTS IN FIELD

ALL EQUIPMENT IS EXISTING EXCEPT WHERE NOTED

NOT FOR CONSTRUCTION
2026-04-02

CONTRACTOR SHALL OBTAIN A COPY OF THE CITY OF COQUITLAM TRAFFIC SIGNAL AND ROADWAY SUPPLEMENTAL SPECIFICATIONS PRIOR TO CONSTRUCTION.

REFER TO THE CITY OF COQUITLAM TRAFFIC SIGNAL APPROVED PRODUCTS LIST FOR ALL EQUIPMENT DETAILS. IF ANYTHING IS NOT LISTED, COORDINATE WITH CITY TRANSPORTATION GROUP.

USE #7 CONDUCTOR FOR SECONDARY PB RETURN TAPE WHITE IN HANDHOLE & CONTROLLER CABINET.

THE CONTRACTOR SHALL COORDINATE ALL TERMINATION IN THE TRAFFIC CONTROLLER WITH THE CONTRACT ADMINISTRATOR.

THE CITY OF COQUITLAM SHALL BE RESPONSIBLE FOR PROGRAMMING CHANGES TO THE TRAFFIC SIGNAL INCLUDING THE VIDEO DETECTION SYSTEM. CONTRACTOR SHALL PROVIDE THE CITY 3 WEEKS NOTICE IN ADVANCE OF WORK BEING REQUIRED. ALL COST RELATED TO THIS WORK WILL BE BORNE BY THE CITY.

BC CALL BEFORE YOU DIG
 1-800-474-6886
 or by CELLULAR 4888
 Vancouver Area 257-840

COQ. ASBULT No. EXXXX

CALL AT LEAST TWO FULL WORKING DAYS BEFORE YOU PLAN TO DIG

Benchmark:
 Contractor to contact Telus, BC Hydro, FortisBC and BC one call prior to construction to confirm locations of utilities and appurtenances requiring adjustment.

DMD & Associates
 Electrical Consultants Ltd.
 #12-11358 104th Avenue, Surrey, BC, Canada V4N 0A3
 www.dmdeng.com 604-589-9010
 office@dmdeng.com Fax 604-589-9012
 DMD PROJECT No. 8358-24-04 of 04

No.	Date	By	Revisions
1	02-04-2026	BG	ADDENDUM #1 - POLE 2 LOCATION AND POLE TYPE CHANGE
	05-03-2026	BG	ISSUED FOR TENDER
	21-01-2026	BG	DETAILED SUBMISSION

ACCEPTED FOR CONSTRUCTION
 Date: _____
 Manager of Development Servicing

Coquitlam
 Engineering & Public Works
 3000 Guildford Way, Coquitlam, B.C. V3B 7N2

PERMIT TO PRACTICE
 Signature: _____
 Date: 02-04-2026
 PERMIT NUMBER: 1000771
 The Association of Professional Engineers and Geoscientists of British Columbia



Design by	Date	Scale
BP	12-12-2024	AS NOTED
Drawn by	Date	Sheet of
YJ	12-12-2024	4 OF 4
Checked by	Date	Eng. Project No.
NB	12-12-2024	
Approved by	Date	
	12-12-2024	

Project: **GUILDFORD WAY LANSDOWNE DRIVE TRAFFIC SIGNAL MODIFICATIONS**
 Description:
 File: 8358-24

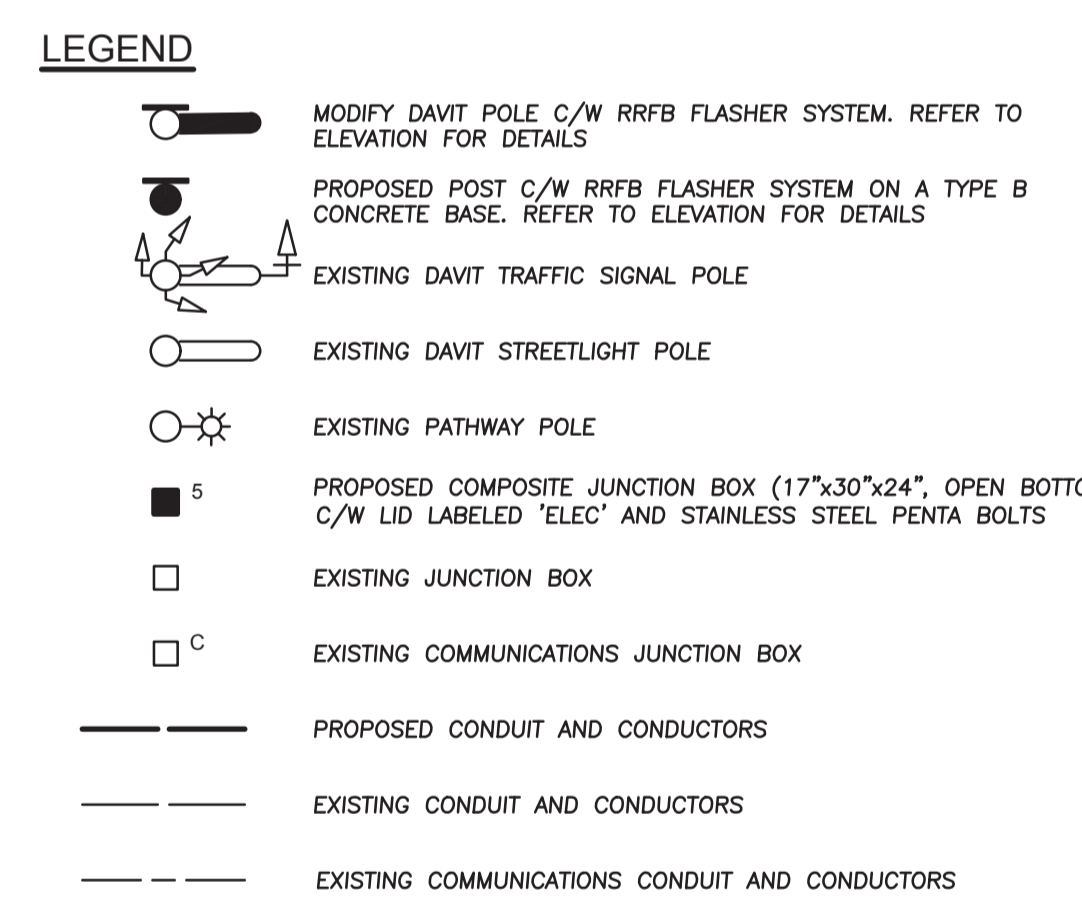
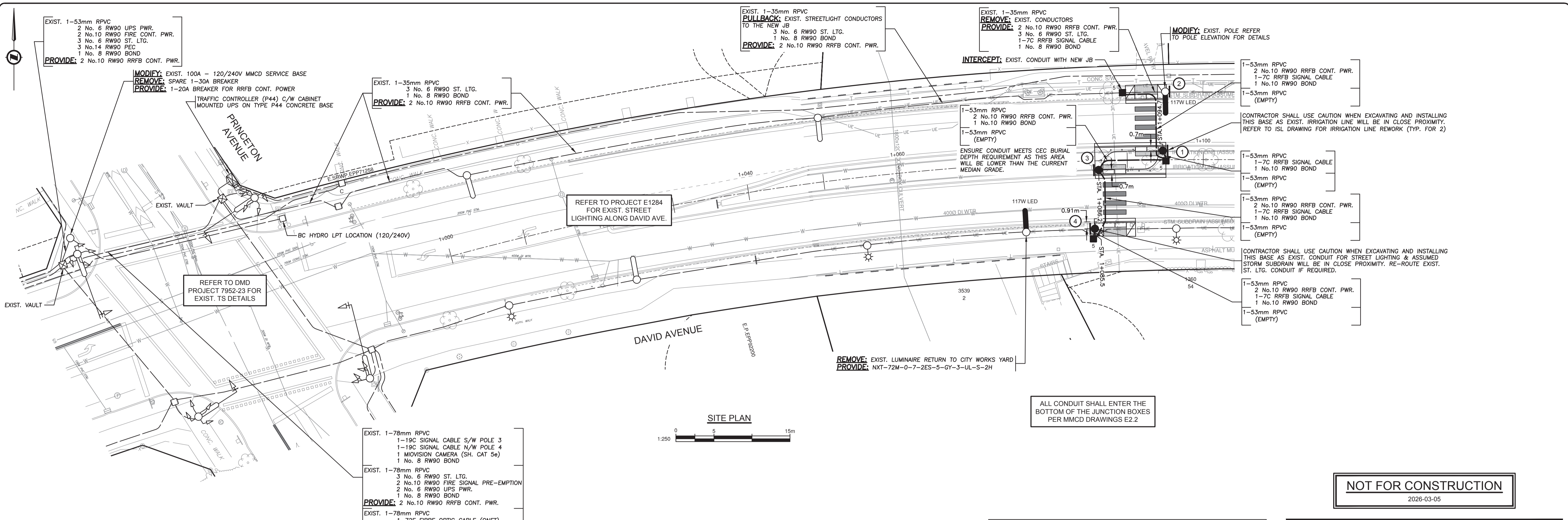

- NOTES**
- ALL WORK SHALL BE CONSTRUCTED IN ACCORDANCE (IN ORDER OF PRECEDENCE) WITH THE SUPPLEMENTAL SPECIFICATIONS, MASTER MUNICIPAL CONSTRUCTION DOCUMENT, 2019 ISSUE AND THE CURRENT MOTH STANDARD SPECIFICATIONS FOR HIGHWAY CONSTRUCTION UNLESS OTHERWISE NOTED ON DESIGN DRAWINGS.
 - CONDUCTORS INSIDE POLES SHALL BE:
No. 14 RW90 X-LINK FOR SIGNALS
No. 12 RW90 X-LINK FOR ALL OTHERS
 - A TRON HEB A4 WEATHERPROOF FUSE HOLDER, C/W A 10A BUSS KTK FUSE AND 2 'L' TYPE INSULATING BOOTS, SHALL BE INSTALLED IN EACH LUMINAIRE & SIGN LIVE CONDUCTOR, IN THE HANDHOLE.
 - ALL SINGLE CONDUCTORS SHALL BE STRANDED COPPER, TYPE RW90 INSULATED AND COLOR CODED.
 - EMPTY CONDUITS SHALL HAVE A No.8 HB POLY YELLOW/GRN MK PULL STRING AND CAPPED AT BOTH ENDS AS PER COQUITLAM SUPPLEMENTARY DRAWING SS-E2.5
 - WHERE INDIVIDUAL CONDUCTORS OR CABLES ARE RUN, ALL OF THE COMMON CIRCUITS SHALL BE BUNDLED, TY-RAPPED TOGETHER WITH IDENTIFICATION TAGS IN ALL JUNCTION BOXES, VAULTS, HAND HOLES, CONTROLLER AND ACCESS POINTS AS NOTED IN THE MMCD. TAGS SHALL BE MARKED AS FOLLOWS CABLE N/W POLE, STREET LIGHTING CCTS R OR B, PHOTOCELL, CONTROLLER POWER, WITH BLACK INDELIBLE MARKING PEN. TAGS TO BE ATTACHED NO FURTHER THAN 75mm FROM WIRE OR CABLE TERMINATION POINT.
 - EQUIPMENT MODELS SPECIFIED SHALL BE CONFIRMED WITH THE CITY IMMEDIATELY PRIOR TO THEIR PURCHASE TO ENSURE THAT THEY ARE CORRECT AND CURRENT. CUTSHEETS, EQUIPMENT, MAKE, MODEL & SERIAL LIST TO BE PROVIDED FOR EACH SIGNAL LOCATION.
 - CONTRACTOR IS REQUIRED TO PROVIDE 72 HOURS NOTICE PRIOR TO ANY CONSTRUCTION.
 - TRAFFIC CONTROL IS REQUIRED TO CITY STANDARDS. (MoTT)
 - ALL POLES, ETC. TO BE GALVANIZED, PRIMED AND POWDER-COATED IN COLOUR. EQUIVALENT TO COQUITLAM LAMP STANDARD GREEN RAL 6026, UNLESS OTHERWISE NOTED OR APPROVED.
 - INSTALL BELL END FITTING ON ALL CONDUITS ENTERING JUNCTION BOXES.
 - INSTALL HANGER BAR & TY-RAP WIRES TO BAR IN JUNCTION BOXES AS PER MMCD DRAWING COQUITLAM SUPPLEMENTARY DRAWING SS-E2.5
 - ALL CONDUITS SHALL BE BURIED MINIMUM 600mm DEEP. A 'BURIED CABLE' MAKER TAPE SHALL BE INSTALLED 300mm ABOVE CONDUIT IN ALL TRENCHES. DETECTABLE (METALIC) TAPE TO BE USED ABOVE CONDUIT IN TRENCHES CONTAINING ONLY INTERCONNECT CONDUIT.
 - BOND ALL STEEL JUNCTION BOX LIDS.
 - CONTRACTOR SHALL REPLACE ALL ASPHALT, CONCRETE SIDEWALKS AND WHEELCHAIR RAMPS REMOVED FOR THE INSTALLATION OF THE SIGNAL AND COMM EQUIPMENT, AND RESTORE TO THE SAME OR BETTER CONDITION.
 - ALL ELECTRICAL PRODUCTS SHALL BEAR CSA/ETC APPROVALS OR BC ELECTRICAL INSPECTION PRIOR TO INSTALLATION.
 - SIGNAL WIRING SHALL BE TAGGED AND LABELED USING PANDUIT MP250-C TAGS AND THE APPROPRIATE PANDUIT INDELIBLE MARKER.
 - SECURITY HARDWARE TO BE USED ON ALL POLES, SECURITY BITS ARE TO BE SUBMITTED TO THE CITY AFTER SIGNAL HAS BEEN FULLY COMPLETED.
 - CONCRETE VAULTS AND JUNCTION BOXES LOCATED IN NON-PAVED OR NON-SIDEWALK AREAS ARE TO BE PROTECTED FROM MOWER OR EROSION/VEGETATION DAMAGE WITH A 200mm WIDE x 150mm DEEP CONCRETE COLLAR FLUSH WITH TOP EDGES OF THE TOP OF THE BOX LID. COLLAR TO SLOPE DOWN AWAY FROM BOX OPENING AT 3% TO DIRECT WATER AWAY FROM BOX OPENING. REFER TO COQUITLAM SUPPLEMENTAL SPECIFICATION FOR DETAILS.
 - JUNCTION BOXES FOR ELECTRICAL APPLICATIONS (TRAFFIC SIGNALS, STREET LIGHTING, ETC.) - THE LIDS SHOULD BE ETCHED ELEC. JUNCTION BOXES FOR COMMUNICATIONS - THE LIDS SHOULD BE ETCHED COMM, ALL UPPERCASE LETTERS.
 - COMPOSITE PULL BOXES SHALL BE INSTALLED AS SHOWN ON STANDARD DETAIL MMCD DRAWING E2.5 C/W BOLT DOWN LID. REPLACE 300mm COARSE DRAIN ROCK WITH 300mm FINE DRAIN ROCK.
 - BOTTOM OF JUNCTION BOXES SHALL BE OPEN. BOTTOM SECTIONS SHALL BE SUPPORTED WITH CONCRETE BRICKS AND USE CRUSHED GRAVEL TO DRAIN WATER.
 - ALL BOLT DOWN JUNCTION BOX LIDS SHALL BE TIER 15 (20K) RATED.

120V SERVICE LOAD
(100A-120/240V SERVICE BASE AT DAVID AVE. AND PRINCETON AVE.)

WATTAGE (W)	CCT.PHASE	EXISTING	REMOVED	NEW	TOTAL No. OF LIGHTS	CURRENT(A)
25W	R	1	0	0	1	0.21A
	B	2	0	0	2	0.42A
45W	R	2	0	0	2	0.75A
	B	2	0	0	2	0.75A
65W	R	3	0	0	3	1.63A
	B	2	0	0	2	1.08A
84W	R	2	0	0	2	1.40A
	B	2	0	0	2	1.40A
92W	R	3	2	0	1	0.77A
	B	4	0	0	4	3.07A
99W	R	2	0	0	2	1.65A
	B	2	0	0	2	1.65A
117W	R	0	0	2	2	1.95A
	B	0	0	0	0	0.00A

0.84% VOLTAGE DROP

NOT FOR CONSTRUCTION
2026-03-05

CAUTION!
EXCAVATION NEAR OVERHEAD UTILITY POLE
ANY UNDERGROUND EXCAVATION WITHIN SOIL FOUNDATION INTERACTION AREA REQUIRES TEMPORARY UTILITY POLE SUPPORT. REFER TO ES55 E3-04 GUIDE FOR CIVIL EXCAVATION NEAR DISTRIBUTION POLES FOR DETAILS. REFER TO BC HYDRO WORK ON WOOD POLES MANUAL (ON SAFEHUB) AND BC HYDRO 2017-1-F POLE HOLDING REQUIREMENTS FOR APPROVED TEMPORARY POLE SUPPORT METHODS. FOR MORE INFORMATION CONTACT workmethods@bchydro.com

LOCATING EQUIPMENT
FOR CLARITY CONDUITS, JUNCTION BOXES AND STREETLIGHT POLES MAY NOT BE SHOWN AT DESIGN OFFSETS. CONTRACTOR SHALL LOCATE ALL EQUIPMENT BASED ON STATIONS AND/OR OFFSETS AS NOTED AND SHALL NOT RELY ON COORDINATES OBTAINED FROM DMD DIGITAL DRAWINGS. CONTRACTOR TO REPORT ANY CONFLICTS OR DISCREPANCIES TO DMD & ASSOCIATES **PRIOR TO ORDERING EQUIPMENT.**

CHECK BEFORE YOU DIG
CONTRACTOR SHALL REFER TO MUNICIPAL RECORD / CIVIL DESIGN DRAWINGS FOR ALL OTHER UTILITIES, SERVICE LOCATIONS, AND DETAILS. THE EXACT LOCATION OF THESE UTILITIES SHALL BE DETERMINED ON SITE BY THE CONTRACTOR. CONTRACTOR TO REPORT ANY CONFLICTS OR DISCREPANCIES TO DMD & ASSOCIATES **PRIOR TO ORDERING BASES.**

OVERHEAD POWER LINE CONFLICTS
CONTRACTOR SHALL CONFIRM ON SITE PRIOR TO CONSTRUCTION THAT POLES & EQUIPMENT WILL MEET WorkSafeBC CLEARANCE REQUIREMENTS FOR OVERHEAD PRIMARY AND SECONDARY LINES. CONTRACTOR TO REPORT ANY CONFLICTS OR DISCREPANCIES TO DMD & ASSOCIATES **PRIOR TO ORDERING POLES AND INSTALLING CONCRETE BASES.**

EXISTING STREET LIGHTING SHALL REMAIN IN OPERATION THROUGHOUT CONSTRUCTION. IF TRAFFIC SIGNAL DE-ENERGIZATION IS REQUIRED CONTRACTOR SHALL ENSURE FULL-TIME FLAGGING IS USED DURING ANY TRAFFIC SIGNAL DOWNTIME.

CALL BEFORE YOU DIG
1-800-474-6886
or by CELLULAR #888
Newcomer Area 257-8440
CALL AT LEAST TWO FULL WORKING DAYS BEFORE YOU PLAN TO DIG

COQ. ASBULT No. **EXXXX**

Benchmark:
Contractor to contact Telus, BC Hydro, FortisBC and BC one call prior to construction to confirm locations of utilities and appurtenances requiring adjustment.

DMD
DMD & Associates
Electrical Consultants Ltd.
#12-11558 1044 Avenue, Surrey, BC, Canada V4N 0A3
www.dmdeng.com 604-589-9010
office@dmdeng.com Fax 604-589-9012
DMD PROJECT No. 8698-26-01 of 02

No.	Date	By	Revisions
05-03-2026	BG		ISSUED FOR TENDER
19-02-2026	BG		PRELIMINARY SUBMISSION

ACCEPTED FOR CONSTRUCTION
Date: _____
Manager of Development Servicing

Coquitlam
Engineering & Public Works
3000 Guildford Way, Coquitlam, B.C. V3B 7N2

PERMIT TO PRACTICE
Signature: _____
Date: 05-03-2026
PERMIT NUMBER: 1000771
The Association of Professional Engineers and Geoscientists of British Columbia

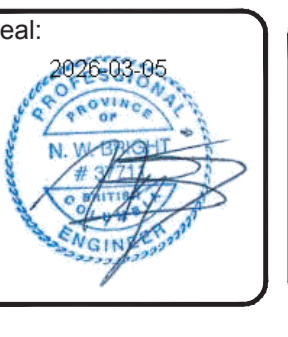

Design by	Date	Scale
BC	2026-02-06	1:250
Drawn by	Date	Sheet of
CA	2026-02-06	1 OF 2
Checked by	Date	Eng. Project No.
NB	2026-02-06	
Approved by	Date	

Project: **DAVID AVENUE EAST OF PRINCETON AVENUE RRFB SPECIAL CROSSWALK**
Description:
File: 8698-26

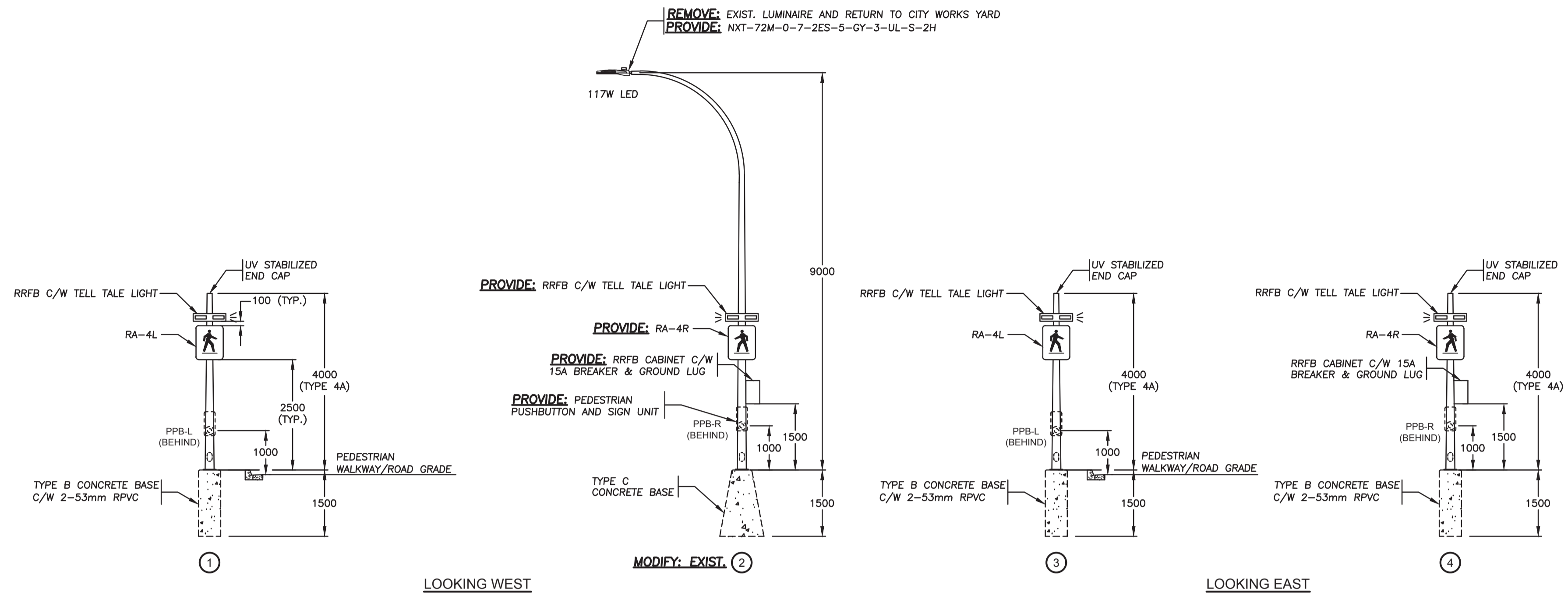

LOOKING WEST

LOOKING EAST

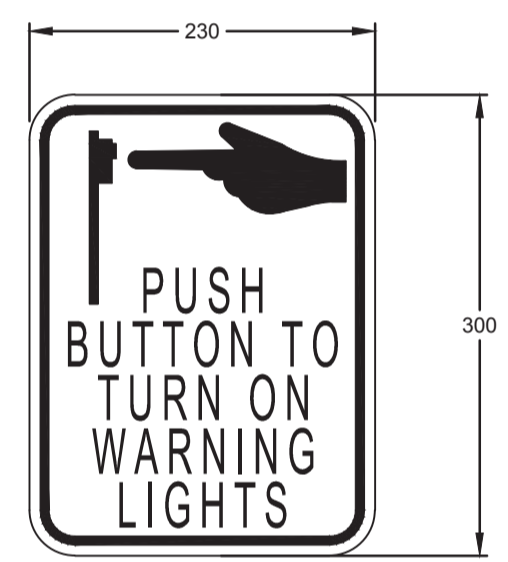

PEDESTRIAN WARNING SIGN DETAIL
N.T.S.

REFER TO CITY OF COQUITLAM TRAFFIC SIGNAL APPROVED PRODUCTS LIST FOR ALL EQUIPMENT DETAIL

NOT FOR CONSTRUCTION
2026-03-05

ADDITIONAL APPROVED PRODUCT LIST			
PRODUCT	MANUFACTURER	SPECIFICATION	EXCEPTIONS
RECTANGULAR RAPID FLASH BEACON (RRFB)	JSF TECHNOLOGIES	9000 SERIES-AB-9407-AC-4RRFB-COB LABEL CONTROLS INSIDE	YELLOW, JAW MOUNTS
RRFB CABINET	JSF TECHNOLOGIES		C/W 15A BREAKER & GROUND LUG
PUSH BUTTON SIGN PLATE	POLARA	PBF2C-9"x12"-Y	

THE CONTRACTOR SHALL BE RESPONSIBLE FOR PROGRAMMING THE RRFB IN ACCORDANCE WITH THE TIMING SHEET PROVIDED BY CITY OF COQUITLAM. THE CONTRACTOR SHALL PROVIDE THE CITY 5 BUSINESS DAYS NOTICE.

CONTRACTOR SHALL OBTAIN A COPY OF THE CITY OF COQUITLAM TRAFFIC SIGNAL AND ROADWAY SUPPLEMENTAL SPECIFICATIONS PRIOR TO CONSTRUCTION.

CALL BEFORE YOU DIG!
1-800-474-6886
or by CELLULAR #888
Vancouver Area 257-8440

CALL AT LEAST TWO FULL WORKING DAYS BEFORE YOU PLAN TO DIG

COQ. ASBUILT No.
EXXXX

Benchmark:
Contractor to contact Telus, BC Hydro, FortisBC and BC one call prior to construction to confirm locations of utilities and appurtenances requiring adjustment.

DMD & Associates
Electrical Consultants Ltd.
#12-17358 104A Avenue, Surrey, BC, Canada V4N 5K3
www.dmdeng.com 604-589-9010
office@dmdeng.com Fax 604-589-9012
DMD PROJECT No. 8698-26-02 of 02

No.	Date	By	Revisions
05-03-2026	BG		ISSUED FOR TENDER
19-02-2026	BG		PRELIMINARY SUBMISSION

ACCEPTED FOR CONSTRUCTION
Date: _____
Manager of Development Servicing

Coquitlam
Engineering & Public Works
3000 Guildford Way, Coquitlam, B.C. V3B 7N2

PERMIT TO PRACTICE
Signature: _____
Date: 05-03-2026
PERMIT NUMBER: 1000771
The Association of Professional Engineers and Geoscientists of British Columbia

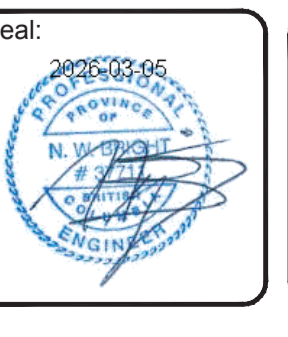

Design by	Date	Scale
BG	2026-02-06	1:250
Drawn by	Date	Sheet of
CA	2026-02-06	2 OF 2
Checked by	Date	Eng. Project No.
NB	2026-02-06	
Approved by	Date	

Project: **DAVID AVENUE EAST OF PRINCETON AVENUE**
Description: **RRFB SPECIAL CROSSWALK**
File: 8698-26